



# Helendale Community Services District Regular Board Meeting

26540 Vista Road, Suite C, Helendale, CA 92342

**Thursday, October 15, 2020 at 6:30 PM**

## **SPECIAL NOTICE OF TELECONFERENCE ACCESSIBILITY**

Pursuant to the provisions of Executive Order N-29-20 issued by Governor Gavin Newsom in response to the COVID-19 pandemic and in an effort to prevent the spread of the virus, Helendale CSD will hold its board meeting via teleconference. The Helendale CSD Board of Directors will meet in person at the District Office located at 26540 Vista Rd. Suite C. Helendale, CA 92342. This meeting is open to the public via virtual interface and can be accessed by clicking on the link below.

<https://attendee.gotowebinar.com/register/6904676146957413131>

(Dial-in instructions will be provided after registering at the link above)

## **Call to Order - Pledge of Allegiance**

### **1. Approval of Agenda**

### **2. Public Participation**

*Anyone wishing to address any matter pertaining to District business listed on the agenda or not, may do so at this time. However, the Board of Directors may not take action on items that are not on the agenda. The public comment period may be limited to three (3) minutes per person. Any member wishing to make comments may do so by filling out the speaker's card at the following link: <https://www.surveymonkey.com/r/HKGNLL8>. We request that all speaker's cards are filled out by 6:25 pm.*

### **3. Consent Items**

- a. Approval of Minutes: October 1, 2020, Regular Board Meeting
- b. Directors Compensation and Expenses
- c. Bills paid report
- d. August Financials

### **4. Reports**

- a. Directors' Reports
- b. General Manager's Report

## **Regular Business:**

5. Discussion Only Regarding COVID-19 Pandemic Update
6. Discussion Only Regarding Mandatory Testing Requirements for PFAS
7. Discussion and Possible Action Regarding Parking Lot Lighting at the Community Center
8. Discussion and Possible Action Regarding Cost of Park Elements for Grant Application

## **Other Business**

9. Requested items for next or future agendas (Directors and Staff only)

## **Closed Session**

### **10. Conference with Real Property Negotiators (Government Code Section 54956.8)**

Property: APN's: 0467-021-33; 0466-181-25; 0466-618-26

District Negotiator: Kimberly Cox, General Manager

Negotiating Parties: US Materials

Under Negotiation: Price and Terms of Payment

### **11. Conference with Real Property Negotiators (Government Code Section 54956.8)**

Property: APN's: 0467-121-28, 0467-121-22

District Negotiator: Kimberly Cox, General Manager

Negotiating Party: Carl Ross Living Trust

Under Negotiation: Price and Terms of Payment

### **11A. Conference with Real Property Negotiators**

Government Code Section 54956.8

Property: Various

District Negotiator: Kimberly Cox

Negotiating Parties: Robert Boytor

Under Negotiation: Price and Terms of Payment

### **12. Report of Closed Session Items**

### **13. Adjournment**

*Pursuant to Government Code Section 54954.2(a), any request for a disability-related modification or accommodation, including auxiliary aids or services, that is sought in order to participate in the above agenda public meeting should be directed to the District's General Manager's office at (760) 951-0006 at least 24 hours prior to said meeting. The regular session of the Board meeting will be recorded. Recordings of the Board meetings are kept for the Clerk of the Board's convenience. These recordings are not the official minutes of the Board meetings.*



# Helendale Community Services District

---

**Date:** October 15, 2020  
**TO:** Board of Directors  
**FROM:** Kimberly Cox, General Manager  
**SUBJECT:** Agenda item #3  
Consent Items

---

## **CONSENT ITEMS**

- a. Approval of Minutes: Regular Board Meeting of October 1, 2020
- b. Bills Paid Report
- c. Directors Expenses
- d. August Financials



# Helendale Community Services District

---

**Date:** October 15, 2020  
**TO:** Board of Directors  
**FROM:** Kimberly Cox, General Manager  
**BY:** Cheryl Vermette  
**SUBJECT:** Agenda item #3a  
Minutes from Board meetings 10/1/2020

---



*Minutes of the Helendale Community Services District  
BOARD OF DIRECTORS MEETING  
October 1, 2020 at 6:30 PM  
26540 Vista Road, Suite C. Helendale, CA 92342*

Pursuant to the provisions of Executive Order N-29-20 issued by Governor Gavin Newsom in response to the COVID-19 pandemic and in an effort to prevent the spread of the virus, Public Participation in Helendale CSD's Board Meeting was held via teleconference.

**Board Members Roll Call:**

**Present:** President Ron Clark; Vice President Tim Smith; Secretary Sandy Haas; Director Craig Schneider; Director Henry Spiller

**Staff Members Present:**

Kimberly Cox, General Manager  
Cheryl Vermette, Program Coordinator

**Consultants:**

Steve Kennedy, Legal Counsel (via teleconference)

**Members of the Public:**

There were two members of the public present via the teleconference link.

**Call to Order and Pledge of Allegiance**

The meeting was called to order at 6:30 pm by President Ron Clark, after which the Pledge of Allegiance was recited.

**1. Approval of Agenda**

**Action:** A motion was made by Director Schneider to approve the agenda as amended. The motion was seconded by Director Haas.

**Vote:** Motion carried by the following vote: 5 Yes; 0 No

**2. Public Participation**

None

**3. Consent Items**

a. Approval of Minutes: September 17, 2020 Regular Board Meeting & September 19<sup>th</sup> Special Board Meeting

b. Directors Compensation and Expenses

c. Bills Paid Report

**Action:** A motion was made by Vice-President Smith to approve the consent items as presented. The motion was seconded by Director Spiller.

**Vote:** Motion carried by the following vote: 5 Yes; 0 No

**4. Reports**

a. Directors' Reports

Director Schneider reported that he staffed the booth at the Farmers Market and talked to residents about the park grant.

Director Spiller reported that he too staffed the booth at the Farmers Market and talked to residents about the park grant.

b. General Manager's Report

General Manager Cox reported that there will be construction on National Trails Highway beginning on 9/30 and going through 10/8 from 8:00 am to 5:00 pm/ The railroad is doing construction on the bridge. There will be no hard road closures and there will be flaggers to allow for traffic flow.

She also reported that the final public input meeting for the park grant will be held on 10/19 at 5:00 pm. This will be agendized as a Special Board meeting to allow full participation by the Board. A resolution for the grant application will be on the Board agenda on 11/5. The input has been very productive, and the park rendering should be ready in a few weeks.

Water Operations Manager Craig Carlson gave the water report. Staff has been working on the meter replacement program and are ahead of schedule with the Strategic Partners Grant. Staff repaired two leaks at Fairway Courts, a broken main line on Peninsula, assisted Wastewater on the installation of a new sewer lateral on Peninsula and installed a new 2" meter at North Beach. We also completed the safety equipment inventory and will be ordering new safety supplies. Staff installed the mattress lift at the thrift store and converted the electric to battery powered hydraulic. All monthly inspections have been completed for September. Carlson showed several photos of the broken main line on Peninsula.

### **Regular Business**

#### **5. Discussion Only Regarding COVID-19 Pandemic Update**

**Discussion:** The District continues to monitor the information released by the state. Staff continues to monitor cash flow. There are \$29,677 in back payments and 36 out of the 139 past due accounts paid this week. The local School District has applied for a waiver to begin K-6<sup>th</sup> in class instruction possibly by 10/26. Guidance has been issued for trick-or-treating and playgrounds. Every Tuesday the State releases the County standings.

**Motion:** There was no motion on this item.

#### **6. Discussion and Possible Action Regarding Community Center Allocation/Reallocation of Space**

**Discussion:** Unit D is currently vacant, and we are using it for the Farmers Market vendors for the time being. Some repairs are necessary including painting, drywall repair and concrete repair. Climate control is limited; the unit has three swap coolers that work marginally in that large of a space and one natural gas space heater that is not adequate. The intention of this discussion is to stimulate a brainstorming session on how the Board wishes to reallocate that space for public use. Staff's role is to facilitate the process and perform research on various options as requested by the Board. Staff requested concurrence from the Board on options for evaluation. The Board reviewed drawings of the building and discussed different options. The consensus of the Board that the main priorities included painting the walls and repairing the concrete, not putting in carpet for now, and addressing the heating and air conditioning. They also wanted to see that the restrooms were addressed ASAP. The Board also discussed changing the design of Unit C and D opening the space into one larger room with accordion doors between the two units to be able to split the space when needed and creating a permanent Board room.

**Motion:** There was no motion on this item. The Board directed Staff to paint the walls, repair floors and investigate options for heating and cooling the space.

#### **7. Discussion and Possible Action Regarding Water Rights and Water Production**

**Discussion:** The District has been forward thinking in acquiring water rights and currently has sufficient water rights. The excess water rights are leased out annually. A judge ramped

down use in the last Water Year from 60% to 55%. Staff received a call regarding a potential subdivision of approximately 700 homes. The District would currently have enough water to service that new demand.

Conservation. The District has repaired old water lines saving over 600-acre feet per year. The community has done a tremendous job on conservation and has reduced approximately 178-acre feet from 2011 to current.

General Manager Cox presented a chart showing Base annual production, free production allowance and water pumped from Water Year 2006/2007 through Water Year 2019/2020. The water supply fee was implemented in 2009 costing \$5,000 per new home, which purchases 1-acre foot (AF) of water – the ramped down amount (55% of 1 AF) is 239 Hundred Cubic Feet (HCF). The average customer usage is 180 HCF per year. Since that time 28 homes have been constructed and \$140,000 in fees have been collected. In 2011, the District purchased 500 AF of storage water from MWA at \$386/AF. The current MWA rate is not to exceed \$662. On face value increase in inventory is \$276 but the final lease price is MWA's final rate and market conditions. The estimate is that market will be 10% below the MWA rate. Staff requested to liquidate storage water.

**Motion:** Director Spiller made the motion to approve the use of Water from MWA Inventory Claim Program. Vice President Smith seconded the motion.

**Vote:** The was approved by the following 5 Yes – 0 No. Roll call vote: President Clark – Yes; Vice President Smith – Yes; Secretary Haas – Yes; Director Schneider – Yes; Director Spiller – Yes

#### **Other Business**

8. Requested items for next or future agendas (Directors and Staff only)  
Director Schneider requested to review the District's Water Rights

President Clark called for a brief recess at 7:30 pm after which closed session began.

#### **Closed Session**

President Clark called Closed Session to order at 7:35 pm.

9. Conference with Real Property Negotiators (Government Code Section 54956.8)  
Property: APN's: 0467-021-33; 0466-181-25; 0466-618-26  
District Negotiator: Kimberly Cox, General Manager  
Negotiating Parties: US Materials  
Under Negotiation: Price and Terms of Payment
10. Conference with Real Property Negotiators (Government Code Section 54956.8)  
Property: APN's: 0467-121-28, 0467-121-22  
District Negotiator: Kimberly Cox, General Manager  
Negotiating Party: Carl Ross Living Trust  
Under Negotiation: Price and Terms of Payment
11. Conference with Real Property Negotiators  
Government Code Section 54956.8  
Property: Various  
District Negotiator: Kimberly Cox  
Negotiating Parties: Robert Boytor  
Under Negotiation: Price and Terms of Payment

**12. Report of Closed Session Items**

Closed Session adjourned at 7:55 pm at which time President Clark called to order the Open Session. Legal Counsel Kennedy announced there was no action resulting from any of the closed session items.

**13. Adjournment**

**Action:** President Ron Clark adjourned the meeting at 7:56 pm

Submitted by:

Approved By:

---

Ron Clark, President

---

Sandy Haas, Secretary

*The Board actions represent decisions of the Helendale Community Services District Board of Directors. A digital voice recording and copy of the PowerPoint presentation are available upon request at the Helendale CSD office.*





# Helendale Community Services District

---

**Date:** October 15, 2020  
**TO:** Board of Directors  
**FROM:** Kimberly Cox, General Manager  
**BY:** Sharon Kreinop  
**SUBJECT:** Agenda item #3b  
Bills Paid Report

---



# Helendale Community Services District

---

**Date:** October 15, 2020  
**TO:** Board of Directors  
**FROM:** Kimberly Cox, General Manager  
**BY:** Cheryl Vermette  
**SUBJECT:** Agenda item #3c  
Presentation of Directors' Expenses

---

## **STAFF REPORT:**

Attached for the Board's consideration is a spreadsheet that outlines Director's expenses paid for the current pay period.

**Director's Expenses**  
**Pay Period Ending October 11, 2020**

<b>Name:</b>		<b>Sandy Haas</b>	
	<b>Date</b>	<b>Activity</b>	<b>Rate</b>
1	10/1/2020	Regular Board Meeting	\$137.50
2	10/2/2020	Meeting with General Manager	\$137.50
3	10/6/2020	Meeting with General Manager	\$137.50
4	10/7/2020	Meeting with General Manager	\$137.50
5	10/8/2020	Meeting with Program Coordinator	\$137.50
		Miles	\$0.00
		Meals	\$0.00
		Lodging	\$0.00
		Other	\$0.00
Total this Pay Period			\$687.50

<b>Name:</b>		<b>Tim Smith</b>	
	<b>Date</b>	<b>Activity</b>	<b>Rate</b>
1	9/29/2020	Meeting with General Manager	\$137.50
2	10/1/2020	Regular Board Meeting	\$137.50
		Miles	\$0.00
		Meals	
		Lodging	\$0.00
		Other	
Total this Pay Period			\$275.00

<b>Name:</b>		<b>Ron Clark</b>	
	<b>Date</b>	<b>Activity</b>	<b>Rate</b>
1	9/2/2020	Meeting with General Manager	\$137.50
2	9/3/2020	Regular Board Meeting	\$137.50
3	9/6/2020	Meeting with General Manager	\$137.50
4	9/7/2020	Regular Board Meeting	\$137.50
5	9/19/2020	Special Park Planning Meeting	\$137.50
		Miles	\$0.00
		Meals	
		Lodging	\$0.00
		Other	
Total this Pay Period			\$687.50

**Name: Craig Schneider**

	<b>Date</b>	<b>Activity</b>	<b>Rate</b>
1	9/29/2020	Meeting with General Manager	\$137.50
2	9/30/2020	Park Planning Table at Farmers Market	\$137.50
3	10/1/2020	Regular Board Meeting	\$137.50
4	10/7/2020	Park Planning Table at Farmers Market	\$137.50
		Miles	\$0.00
		Meals	
		Lodging	\$0.00
		Other	
<b>Total this Pay Period</b>			<b>\$550.00</b>



# Helendale Community Services District

---

**Date:** October 15, 2020  
**TO:** Board of Directors  
**FROM:** Kimberly Cox, General Manager  
**SUBJECT:** Agenda item #3d  
August Financials

---

**STAFF REPORT:**

Attached for the Board's consideration is the financial report for August.

**Helendale CSD**  
**Statement of Revenues and Expenses - Water**  
**As of August 31, 2020**  
**(Unaudited)**

	August 2020	YTD Actual	Budget	% Budget	PYTD
<b>1 Operating Revenues</b>					
2 Meter Charges	\$ 134,106	\$ 265,115	\$ 1,578,873	17%	\$ 242,205
3 Water Sales	107,028	207,308	862,015	24%	190,905
4 Standby Charges	-	-	24,400	0%	171
5 Other Operating Revenue	14,329	18,383	86,232	21%	13,522
<b>6 Total Operating Revenues</b>	<b>255,464</b>	<b>490,806</b>	<b>2,551,520</b>	<b>19%</b>	<b>446,803</b>
<b>7 Non-Operating Revenues</b>					
8 Grant Revenue	-	16,000	37,500	43%	-
9 Miscellaneous Income (Expense)	-	-	1,000	0%	-
<b>10 Total Non-Operating Revenues</b>	<b>-</b>	<b>16,000</b>	<b>38,500</b>	<b>42%</b>	<b>-</b>
<b>11 Total Revenues</b>	<b>255,464</b>	<b>506,806</b>	<b>2,590,020</b>	<b>20%</b>	<b>446,803</b>
<b>12 Expenses</b>					
<b>13 Salaries &amp; Benefits</b>					
14 Salaries	38,937	56,243	330,774	17%	60,730
15 Benefits	15,446	26,320	123,793	21%	40,490
<b>16 Total Salaries &amp; Benefits</b>	<b>54,384</b>	<b>82,564</b>	<b>454,567</b>	<b>18%</b>	<b>101,220</b>
<b>17 Transmission &amp; Distribution</b>					
18 Contractual Services	735	19,502	39,050	50%	8,233
19 Power	18,247	32,450	124,106	26%	22,806
20 Operations & Maintenance	4,974	10,684	131,682	8%	19,714
21 Rent/Lease Expense	800	2,230	10,860	21%	1,600
22 Permits & Fees	-	2,032	25,600	8%	420
<b>23 Total T&amp;D</b>	<b>24,757</b>	<b>66,898</b>	<b>331,298</b>	<b>20%</b>	<b>52,773</b>
<b>24 General &amp; Administrative</b>					
25 Utilities	502	881	5,436	16%	912
26 Office & Other Expenses	278	528	3,015	18%	90
27 Admin Allocation	46,517	93,035	558,207	17%	81,918
<b>28 Total G&amp;A</b>	<b>47,298</b>	<b>94,443</b>	<b>566,658</b>	<b>17%</b>	<b>82,921</b>
29 Debt Service	9,132	158,579	388,734	41%	159,145
<b>30 Total Expenses</b>	<b>135,570</b>	<b>402,484</b>	<b>1,741,257</b>	<b>23%</b>	<b>396,058</b>
<b>31 Net Income (Loss) Before Capital</b>	<b>119,894</b>	<b>104,322</b>	<b>848,763</b>	<b>12%</b>	<b>50,745</b>
32 Capital Expenses	(2,430)	(2,430)	(2,023,667)	0%	-
<b>33 Net Income (Loss) After Capital</b>	<b>\$ 117,464</b>	<b>\$ 101,892</b>	<b>\$ (1,174,904)</b>		<b>\$ 50,745</b>

**Helendale CSD**  
**Financial Statement Analysis**  
For the Month Ended August 31, 2020 – 16% of Fiscal Year

**Fund 01-Water Revenues and Expenses**

**Line 2 Meter Charges:** Meter Charges are the fixed monthly charge for water service. Year to date (YTD) meter charges is trending on budget.

**Line 3 Water Sales:** Water Sales reflects water consumption and is trending above budget due to higher consumption on the summer months.

**Line 4 Standby Charges:** Standby Charges includes special assessment standby charges for the current & prior years, and delinquent standby penalties. Year to Date (YTD) can trend over/under budget due to timing of assessment receipts and unbudgeted receipts of delinquent assessments.

**Line 5 Other Operating Revenue:** Other Operating Revenue includes permit & inspection charges, connection fees, meter installation fees, other fees/charges & mechanic service reimbursements. Connection & meter installation fees are budgeted conservatively due to the unexpected nature of these fees. YTD is at 21% due to connections fees in August.

**Line 8 Grant Revenue:** YTD balance consists of a \$16.0K award for MWA Meter Replacement Program. Budget for this account consists of the remaining \$37.5K grant from the Bureau of Reclamation for installation of AMI smart meters.

**Line 9 Miscellaneous Income (Expense):** Miscellaneous Income includes gain/loss on sale of assets, the Enel X Demand Response Program & other miscellaneous income.

**Line 14 Salaries:** Amounts for water department employees and share of mechanic's payroll. YTD is trending on budget.

**Line 15 Benefits:** Benefits includes health insurance, CalPERS retirement, worker's compensation insurance, payroll taxes, and employee education and trainings. YTD is trending slightly higher than budgeted due to the annual worker's compensation renewal which came in higher than budgeted for due to the reclassification of certain employees

**Line 16 Total Salaries & Benefits:** Salaries & Benefits include all salaries & benefits paid.

**Line 18 Contractual Services:** Contract Services includes lab testing, engineering, GIS support & other contract services. YTD is trending at 50% due to invoices for annual GIS Software \$4.8K and \$9.1K to Tyler Technologies for meter data sync.

**Line 19 Power:** This account includes electricity used for transmission & distribution. YTD is trending at 26% due to increased demand.

**Line 20 Operations & Maintenance:** This line includes operations & maintenance expense, vehicle maintenance & vehicle fuel. Year to Date (YTD) can trend over/under budget due to timing of work performed.

**Line 21 Rent/Lease Expense:** Rent/Lease Expense includes rental costs for the water shop & BLM tank sites.

**Line 22 Permits & Fees:** Includes all water permits, miscellaneous fees, and Watermaster fees. Year to Date (YTD) can trend over/under budget due to timing of payments.

**Line 25 Utilities (G&A):** Utilities includes gas & telephone expenses. YTD is trending on budget at 16%.

**Line 26 Office & Other Expenses:** Office & Other includes mileage/travel reimbursements, office supplies, water conservation program, and dues & subscriptions. Year to Date (YTD) can trend over/under budget due to timing of payments.

**Line 27 Administrative Allocation:** This is the monthly distribution of the budgeted Fund 10 (Administration fund) expenses to the enterprise funds.

**Line 29 Debt Service:** Debt Service includes Interest & Principal payments on outstanding debt.

**Line 32 Capital Expenses:** YTD balance in Capital expenses includes the following:

- \$2.4K - Well Exploration Test Holes



**Helendale CSD**  
**Statement of Revenues and Expenses - Sewer**  
**As of August 31, 2020**  
**(Unaudited)**

	August 2020	YTD Actual	Budget	% Budget	PYTD
<b>1 Operating Revenues</b>					
2 Sewer Charges	\$ 106,799	\$ 213,506	\$ 1,279,029	17%	\$ 213,307
3 Standby Charges	-	-	21,350	0%	1,003
4 Other Fees & Charges	4,726	5,938	15,438	38%	2,608
5 Other Income/(Expense)	-	-	-	0%	-
<b>6 Total Revenues</b>	<b>111,524</b>	<b>219,444</b>	<b>1,315,817</b>	<b>17%</b>	<b>216,919</b>
<b>7 Expenses</b>					
<b>8 Salaries &amp; Benefits</b>					
9 Salaries	31,099	45,184	258,397	17%	34,167
10 Benefits	14,217	23,099	97,812	24%	34,182
<b>11 Total Salaries &amp; Benefits</b>	<b>45,316</b>	<b>68,283</b>	<b>356,209</b>	<b>19%</b>	<b>68,349</b>
<b>12 Sewer Operations</b>					
13 Contractual Services	660	9,173	77,400	12%	7,935
14 Power	6,739	14,431	79,750	18%	17,758
15 Operations & Maintenance	2,789	5,975	63,363	9%	8,435
16 Permits & Fees	2,966	3,976	27,617	14%	4,084
<b>17 Total Sewer Operations</b>	<b>13,154</b>	<b>33,554</b>	<b>248,130</b>	<b>14%</b>	<b>38,211</b>
<b>18 General &amp; Administrative</b>					
19 Utilities	376	739	5,616	13%	677
20 Office & Other Expenses	564	2,868	7,393	39%	625
21 Admin Allocation	45,587	91,174	547,043	17%	80,280
<b>22 Total G&amp;A</b>	<b>46,527</b>	<b>94,781</b>	<b>560,052</b>	<b>17%</b>	<b>81,582</b>
23 Debt Service	-	-	75,042	0%	-
<b>24 Total Expenses</b>	<b>104,997</b>	<b>196,618</b>	<b>1,239,433</b>	<b>16%</b>	<b>188,142</b>
<b>25 Net Income (Loss) Before Capital</b>	<b>6,528</b>	<b>22,826</b>	<b>76,384</b>	<b>30%</b>	<b>28,777</b>
26 Capital Expenses	(40,608)	(69,814)	(1,367,000)	5%	-
<b>27 Net Income (Loss) After Capital</b>	<b>\$ (34,080)</b>	<b>\$ (46,988)</b>	<b>\$ (1,290,616)</b>	<b>4%</b>	<b>\$ 28,777</b>

## ***Fund 02 - Sewer Revenues and Expenses***

**Line 2 Sewer Charges:** YTD is trending on budget at 17%.

**Line 3 Standby Charges:** Standby Charges includes special assessment standby charges for the current & prior years, and delinquent standby penalties. Year to Date (YTD) can trend over/under budget due to timing of assessment receipts and unbudgeted receipts of delinquent assessments.

**Line 4 Other Fees & Charges:** Other Fees & Charges includes permit & inspection charges, connection Fees, other fees/charges & delinquent charges on fees. Connection & permit fees are budgeted conservatively due to the unexpected nature of these fees. YTD is at 38% due to connection fees received in August.

**Line 5 Other Income/(Expense):** Other Income includes gain/loss on sale of assets & other misc. income.

**Line 9 Salaries:** Salaries for sewer employees, trending slightly under budget. Salaries for the mechanic are budgeted and accounted for in Line 15, Vehicle Maintenance. YTD is trending on budget at 17%.

**Line 10 Benefits:** Benefits include employee insurance, PERS retirement, workers compensation, payroll taxes, and education and training. YTD is at 24% due to the annual worker's compensation renewal which came in higher than budgeted for due to the reclassification of certain employees

**Line 13 Contractual Services:** Contract Services include lab testing, engineering, GIS support & other contractual services. Year to Date (YTD) can trend over/under budget due to timing of payments.

**Line 14 Power:** YTD is trending near target at 18%.

**Line 15 Operations & Maintenance:** This account includes compost disposal, vehicle maintenance, vehicle fuel, uniforms & small tools. This category will trend under or over budget depending on timing of purchases and work performed.

**Line 16 Permits and Fees:** This accounts for all annual permitting and fees paid to the state. Year to Date (YTD) can trend over/under budget due to timing of payments.

**Line 19 Utilities (G&A):** Utilities includes gas & telephone expenses. YTD is trending slightly under budget.

**Line 20 Office & Other Expenses:** Office & Other includes mileage/travel reimbursements, office supplies, water conservation program, and dues & subscriptions. Year to Date (YTD) can trend over/under budget due to timing of payments.

**Line 21 Administrative Allocation:** This is the monthly distribution of the budgeted Fund 10 (Administration fund) expenses to the enterprise funds.

**Line 23 Debt Service:** Debt Service includes interest & principal payments on outstanding debt. Payments are made twice a year in June & December.

**Line 26 Capital Expenses:** YTD balance in capital expense includes the following:

- \$51.3K Secondary Irrigation Pump Project
- \$18.6K Manhole Cutter Purchase

**Helendale CSD**  
**Statement of Revenues and Expenses - Recycling Center**  
**As of August 31, 2020**  
**(Unaudited)**

	August 2020	YTD Actual	Budget	% Budget	PYTD
<b>1 Operating Revenues</b>					
2 Retail Sales	\$ 25,791	\$ 50,386	\$ 264,000	19%	\$ 49,983
3 Donations	-	-	-	0%	-
4 Board Discretionary Revenue	-	-	(84,380)	0%	-
<b>5 Total Revenues</b>	<b>25,791</b>	<b>50,386</b>	<b>179,620</b>	<b>28%</b>	<b>49,983</b>
<b>6 Expenses</b>					
<b>7 Salaries &amp; Benefits</b>					
8 Salaries	11,421	16,154	136,326	12%	17,361
9 Benefits	2,316	4,794	16,070	30%	5,527
<b>10 Total Salaries &amp; Benefits</b>	<b>13,737</b>	<b>20,949</b>	<b>152,396</b>	<b>14%</b>	<b>22,888</b>
<b>11 Recycling Center Operations</b>					
12 Contractual Services	-	-	4,300	0%	-
13 Operations & Maintenance	1,253	2,016	11,300	18%	1,801
<b>14 Total Recycling Center Operations</b>	<b>1,253</b>	<b>2,016</b>	<b>15,600</b>	<b>13%</b>	<b>1,801</b>
<b>15 General &amp; Administrative</b>					
16 Utilities	825	1,539	8,124	19%	2,401
17 Office & Other Expenses	321	404	3,500	12%	1,905
<b>18 Total G&amp;A</b>	<b>1,146</b>	<b>1,943</b>	<b>11,624</b>	<b>17%</b>	<b>4,305</b>
<b>19 Total Expenses</b>	<b>16,136</b>	<b>24,907</b>	<b>179,620</b>	<b>14%</b>	<b>28,994</b>
<b>20 Net Income (Loss) Before Capital</b>	<b>9,655</b>	<b>25,479</b>	<b>-</b>		<b>20,988</b>
21 Capital Expenses	-	-	-	0%	10,736
<b>22 Net Income (Loss) After Capital</b>	<b>\$ 9,655</b>	<b>\$ 25,479</b>	<b>\$ -</b>	<b>0%</b>	<b>\$ 10,252</b>

### **03-Recycling Center Revenues and Expenses**

**Line 2 Retail Sales:** YTD is trending slight above budget at 19%.

**Line 3 Donations:** Donations is not budgeted due to the unexpected nature of these revenues.

**Line 4 Board Discretionary Revenue:** This line shows the transfer of net cash from the Recycling Center to the Parks & Recreation Fund. This transfer is done at year end so will be zero throughout the fiscal year until June 2021.

**Line 8 Salaries:** Salaries for part-time recycling center employees. YTD is trending below budget at 12%.

**Line 9 Benefits:** Benefits include employee insurance, workers compensation, payroll taxes, and education and training. YTD is at 30% due to the annual worker's compensation renewal which came in higher than budgeted for due to the reclassification of certain employees

**Line 10 Total Salaries & Benefits:** Salaries & benefits include all salaries paid, health insurance, worker's compensation insurance, payroll taxes, and employee education and training.

**Line 12 Contractual Services:** Contract Services includes software support & other contract services. Year to Date (YTD) can trend over/under budget due to timing of payments.

**Line 13 Operations & Maintenance:** Operations & Maintenance includes vehicle maintenance, vehicle fuel, operating supplies & uniforms. Year to Date (YTD) can trend over/under budget due to timing of work performed and payments.

**Line 16 Utilities (G&A):** Utilities includes electric & telephone expenses. YTD is trending slightly over budget.

**Line 17 Office & Other Expenses:** This line includes advertising, bank charges and other miscellaneous expenses. Office & other includes advertising, bank charges, & other misc. expenses. Year to Date (YTD) can trend over/under budget due to timing of payments.

**Line 20 Net Income:** Net income in the Recycling Center is moved to Fund 05 Parks & Recreation at year end through Board Discretionary Revenue.

**Helendale CSD**  
**Statement of Revenues and Expenses - Property Rental**  
**As of August 31, 2020**  
**(Unaudited)**

	August 2020	YTD Actual	Budget	% Budget	PYTD
<b>1 Operating Revenues</b>					
2 Property Rental Revenues	\$ 10,603	\$ 21,427	\$ 128,280	17%	\$ 20,418
3 Other Income	-	-	200	0%	-
4 Board Discretionary Revenue	-	-	-	0%	-
<b>5 Total Revenues</b>	<b>10,603</b>	<b>21,427</b>	<b>128,480</b>	<b>17%</b>	<b>20,418</b>
<b>6 Expenses</b>					
7 Contractual Services	-	-	5,000	0%	200
8 Utilities	392	754	10,111	7%	1,149
9 Operations & Maintenance	173	3,488	6,000	58%	586
10 Debt Service	-	-	85,882	0%	-
<b>11 Total Expenses</b>	<b>565</b>	<b>4,242</b>	<b>106,993</b>	<b>4%</b>	<b>1,935</b>
<b>12 Net Income (Loss)</b>	<b>\$ 10,038</b>	<b>\$ 17,185</b>	<b>\$ 21,487</b>	<b>80%</b>	<b>\$ 18,483</b>

### ***04-Property Rental Revenues and Expenses***

**Line 2 Property Rental Revenues:** Property Rentals includes revenues from 15302 Smithson & 15425 Wild Road. YTD is trending on budget 17%.

**Line 3 Other Income:** Other Income includes delinquent penalties & other misc. income. Due to the unexpected nature of these revenues, these accounts are not budgeted.

**Line 4 Board Discretionary Revenue:** This line shows the transfer of net cash from the Property Rental Fund to Parks & Rec. This entry will be done at year-end for the audit.

**Line 7 Contractual Services:** Contract services includes contractor/handyman expense for installation of appliances, drywall repair, roofing or plumbing repairs. Year to Date (YTD) can trend over/under budget due to timing of payments.

**Line 8 Utilities:** Utilities includes Electric & Gas expense for the rental properties.

**Line 9 Operations & Maintenance:** O&M includes maintenance & other costs relating to the rental properties. Year to Date (YTD) can trend over/under budget due to timing of payments. YTD is at 58% due to \$3K in A/C at the Smithson property in July

**Line 10 Debt Service:** Debt Service includes interest & principal payments on outstanding debt, paid in December and June.

**Line 12 Net Income:** Net income in the Property Rental fund is moved to Fund 05 through Board discretionary revenue at year end at year-end for the audit.

**Helendale CSD**  
**Statement of Revenues and Expenses - Parks & Recreation**  
**As of August 31, 2020**  
**(Unaudited)**

	August 2020	YTD Actual	Budget	% Budget	PYTD
<b>1 Operating Revenues</b>					
2 Program Fees	\$ 543	\$ 1,199	\$ 27,800	4%	\$ 8,956
3 Property Taxes	1,552	3,104	17,160	18%	2,953
4 Donations & Sponsorships	36	1,664	10,790	15%	5,145
5 Rental Income	2,413	5,213	40,100	13%	6,614
6 Developer Impact Fees	1,720	1,720	-	0%	-
7 Grants	-	-	-	0%	-
8 Interfund Transfer Out/(In)	(3,508)	(7,017)	(42,100)	17%	-
9 Board Discretionary Revenue	17,371	35,875	417,004	9%	31,217
<b>10 Total Revenues</b>	<b>20,127</b>	<b>41,759</b>	<b>470,754</b>	<b>9%</b>	<b>54,885</b>
<b>11 Expenses</b>					
<b>12 Salaries &amp; Benefits</b>					
13 Salaries	10,594	15,484	87,564	18%	967
14 Benefits	5,802	8,325	43,903	19%	1,594
<b>15 Total Salaries &amp; Benefits</b>	<b>16,397</b>	<b>23,809</b>	<b>131,467</b>	<b>18%</b>	<b>2,561</b>
16 Program Expense	1,670	5,135	71,439	7%	5,710
17 Contractual Services	-	185	12,560	1%	2,484
18 Utilities	2,854	5,580	56,301	10%	7,024
19 Operations & Maintenance	1,116	7,310	24,216	30%	4,592
20 Permits & Fees	-	-	5,338	0%	-
21 Grant Expense	-	-	-	0%	-
22 Other Expenses	406	303	3,105	10%	204
23 Debt Service	9,132	9,132	40,679	22%	9,698
<b>24 Total Expenses</b>	<b>31,574</b>	<b>51,454</b>	<b>345,106</b>	<b>15%</b>	<b>32,273</b>
<b>25 Net Income (Loss) Before Capital</b>	<b>(11,447)</b>	<b>(9,696)</b>	<b>125,648</b>	<b>-8%</b>	<b>22,612</b>
26 Capital Expenses	-	-	(135,000)	0%	-
<b>27 Net Income (Loss) After Capital</b>	<b>\$ (11,447)</b>	<b>\$ (9,696)</b>	<b>\$ (9,352)</b>	<b>104%</b>	<b>\$ 22,612</b>

## ***05-Parks & Recreation Revenues and Expenses***

**Line 2 Program Fees:** Program Fees include recreation program fees, basketball league fees, youth soccer league fees & farmers market revenue. YTD trending under budget due to lower than planned activity due to Covid-19 restrictions.

**Line 3 Property Taxes:** Property taxes accounts for the transfer of property taxes for streetlight utility expenses. YTD is trending near budget at 18%.

**Line 4 Donations & Sponsorships:** This account includes concert in park sponsorships, event sponsorship and other donations/sponsorships.

**Line 5 Rental Income:** Rental Income Includes rent/lease income from the water shop, storage for the recycling center, unit C room rental, unit D church rental, and unit D gymnastics.

**Line 6 Developer Impact Fees:** Developer Impact Fees are not budgeted due to the unexpected nature of these revenues.

**Line 7 Grant Revenue:** The District anticipates \$130K in grant revenues from the Land and Wildlife Conservation Fund for construction of park facilities. This amount will be received in August or September 2020.

**Line 8 Interfund Transfer Out/(In):** This line shows the transfer of cash balance from the Recycling Center & Property Rental to the Parks & Rec Fund. This entry will be done at year-end in June 2021 when it is known exactly how much net income is available to transfer.

**Line 9 Board Discretionary:** Board Discretionary Revenue in February includes the following:

- Radio Tower Site Rent – \$11,308
- Property Taxes - \$6
- Solid Waste Franchise Fees - \$7,609
- Transfer Property Tax Revenue for Street Light Utilities – \$(1,503)

**Line 13 Salaries:** Amounts for full & part-time parks department employees. YTD is trending near budget at 29%.

**Line 14 Benefits:** Benefits includes health insurance, CalPERS retirement, worker's compensation insurance, payroll taxes, and employee education and trainings. YTD is at 19% due to the annual worker's compensation renewal which came in higher than budgeted for due to the reclassification of certain employees

**Line 16 Program Expense:** Program expense includes supplies/expenses for the youth soccer league, park, community center, farmers market, & other programs. Year to Date (YTD) can trend over/under budget due to timing of payments.

**Line 18 Utilities:** Utilities includes gas, electric for park/community center, telephone & electricity for street lighting.

**Line 19 Operations & Maintenance:** O&M includes maintenance costs for the park & community center, vehicle maintenance, small tools, vehicle fuel and building repair. YTD is at 30% due to timing of insurance renewals and annual software support.

**Line 20 Permits & fees:** This account includes permit/inspection fees & San Bernardino county fees. Year to Date (YTD) can trend over/under budget due to timing of payments.

**Line 22 Other Expenses:** Other expenses includes Uniforms, Printing Costs, Dues & Subscriptions & Bank Charges.

**Line 23 Debt Service:** Debt Service includes interest & principal payments on outstanding debt. Debt Service payments are made quarterly in June, September, December & March.



**Helendale CSD**  
**Statement of Revenues and Expenses - Solid Waste Disposal**  
**As of August 31, 2020**  
**(Unaudited)**

	August 2020	YTD Actual	Budget	% Budget	PYTD
<b>1 Operating Revenues</b>					
2 Charges for Services	\$ 45,613	\$ 88,424	\$ 582,089	15%	\$ 82,263
3 Assessments & Fees	372	713	235,847	0%	342
4 Other Charges	471	994	11,000	9%	3,765
5 Board Discretionary Revenue	-	-	-	0%	-
<b>6 Total Revenues</b>	<b>46,457</b>	<b>90,132</b>	<b>828,937</b>	<b>11%</b>	<b>86,369</b>
<b>7 Expenses</b>					
<b>8 Salaries &amp; Benefits</b>					
9 Salaries	11,443	16,018	79,269	20%	9,568
10 Benefits	4,960	7,557	39,654	19%	6,585
<b>11 Total Salaries &amp; Benefits</b>	<b>16,403</b>	<b>23,575</b>	<b>118,923</b>	<b>20%</b>	<b>16,153</b>
12 Contractual Services	90,750	90,750	540,117	17%	41,473
13 Disposal Fees	14,355	15,466	141,956	11%	16,118
14 Operations & Maintenance	90	441	4,215	10%	550
15 Other Operating Expenses	825	1,351	9,997	14%	26
16 Admin Allocation	930	1,861	11,164	17%	1,638
<b>17 Total Expenses</b>	<b>123,354</b>	<b>133,443</b>	<b>826,373</b>	<b>16%</b>	<b>75,957</b>
<b>18 Net Income (Loss)</b>	<b>\$ (76,898)</b>	<b>\$ (43,311)</b>	<b>\$ 2,564</b>		<b>\$ 10,412</b>

## ***06-Solid Waste Disposal Revenues and Expenses***

**Line 2 Charges for Services – Solid Waste:** This is the charge for regular pick up of solid waste. YTD trending slightly under budget at 15%.

**Line 3 Assessment & Fees:** This account includes special assessments for refuse land use fees for current & prior years. . YTD will trend under of over budget depending on timing of property tax receipts. The majority of these fees are collected in December & April.

**Line 4 Other Charges:** Other charges includes delinquent fees & penalties & penalties on delinquent taxes. Can trend under or over budget depending upon time of year revenues are received.

**Line 5 Board Discretionary Revenue:** This is the amount that would be transferred in from discretionary funds if this fund operates at a deficit for the fiscal year. There was no deficit budgeted for FY 20/21.

**Line 9 Salaries:** This is the salaries for solid waste workers. YTD trending slightly higher than budget at 20%

**Line 10 Benefits:** Benefits include employee insurance, CalPERS retirement, workers compensation, payroll taxes, and education and training. YTD is trending at 19%.

**Line 12 Contractual Services:** Contract Services include Burrtec fees & other misc. contract services. YTD is trending on budget at 17%.

**Line 13 Disposal Fees:** Fees include SB County disposal fees & green waste disposal fees. Can trend under or over budget depending upon time of year expenses are incurred.

**Line 14 Operations & Maintenance:** O&M includes vehicle maintenance, vehicle fuel, operating supplies & uniforms. Can trend under or over budget depending upon time of year expenses are incurred.

**Line 15 Other Operating Expenses:** Other Operating Expenses include rent for park storage, telephone, postage, event expense, public outreach, printing, small tools & bad debt expense. Can trend under or over budget depending upon time of year expenses are incurred.

**Line 16 Admin Allocation:** Admin Allocation shows the monthly transfer allocation of admin expenses to the Solid Waste Fund.

**Helendale CSD**  
**Statement of Revenues and Expenses - Administration**  
**As of August 31, 2020**  
**(Unaudited)**

	August 2020	YTD Actual	Budget	% Budget	PYTD
<b>1 Operating Revenues</b>					
2 Tower Rent	\$ 11,308	\$ 22,711	\$ 150,420	15%	\$ 20,624
3 Property Taxes	6	6	103,844	0%	2,229
4 Solid Waste Billing & Fees	13,294	27,456	149,129	18%	24,165
5 Fees & Charges	1,931	1,961	14,000	14%	3,288
6 Investments	995	2,001	45,000	4%	18,071
7 Other Income	1,424	1,424	6,800	21%	2,290
8 Board Discretionary Revenue	(18,923)	(38,979)	(332,624)	12%	(34,170)
<b>9 Total Revenues</b>	<b>10,035</b>	<b>16,578</b>	<b>136,570</b>	<b>12%</b>	<b>36,497</b>
<b>10 Expenses</b>					
<b>11 Salaries &amp; Benefits</b>					
12 Salaries	61,290	88,863	511,463	17%	71,467
13 Benefits	17,291	25,401	200,548	13%	33,119
14 Directors' Fees	7,288	9,289	89,000	10%	6,217
<b>15 Total Salaries &amp; Benefits</b>	<b>86,227</b>	<b>124,073</b>	<b>801,011</b>	<b>15%</b>	<b>110,913</b>
16 Contractual Services	25,322	44,609	217,210	21%	72,618
17 Insurance	-	64,791	84,673	77%	52,803
18 Utilities	2,678	4,353	25,732	17%	1,761
19 Operations & Maintenance	7	132	5,216	3%	150
20 Permits & Fees	701	10,757	14,685	73%	6,106
21 Office & Other Expenses	2,527	13,719	54,122	25%	11,404
22 Admin Allocation	(93,035)	(186,069)	(1,116,414)	17%	(163,837)
<b>23 Total Expenses</b>	<b>24,428</b>	<b>76,365</b>	<b>106,235</b>	<b>72%</b>	<b>91,918</b>
<b>24 Net Income (Loss)</b>	<b>\$ (14,393)</b>	<b>\$ (59,787)</b>	<b>\$ 30,335</b>		<b>\$ (55,422)</b>

## **10-Administrative Revenues and Expenses**

**Line 2 Tower Rent:** Tower Rent includes radio tower site rent. YTD is trending slightly under budget.

**Line 3 Property Taxes:** This account includes current & prior property tax & penalties. YTD will trend under or over budget depending on timing of property tax receipts. The majority of receipts are in December and April.

**Line 4 Solid Waste Billing & Fees:** This includes franchise fees & billing for solid waste. YTD is trending at budget at 18%.

**Line 5 Fees & Charges:** Fees & charges consists of credit card processing fees & other misc. fees. YTD is trending a little under budget at 14%.

**Line 6 Investments:** This account includes investment income & unrealized gain/loss on investments.

**Line 7 Other Income:** Other Income includes recycling revenues & other misc. income. Year to Date (YTD) can trend over/under budget due to timing of receipts.

**Line 8 Board Discretionary Income:** Board Discretionary Revenue includes the transfer of the following for Fund 05:

- Radio Tower Site Rent – \$11,308 (line 2)
- Property Taxes - \$6 (line 3)
- Solid Waste Franchise Fees - \$7,609 (part of line 4)

**Line 12 Salaries:** Salaries Expense includes full time, part time & overtime labor. YTD is trending on budget at 17%.

**Line 13 Benefits:** Expense in this category include: employee group insurance, workers compensation, payroll taxes, employment expense, education & training, and employee benefit & morale. YTD is trending below budget at 13% due to timing employee morale & training expenses.

**Line 14 Directors' Fees:** This category includes directors fees as well as directors training, seminars & mileage expense. YTD is trending under budget at 10%.

**Line 16 Contractual Services:** Contract Services include software support, legal services, & auditing/accounting services. YTD is at 20% due to higher than anticipated legal costs.

**Line 17 Insurance:** This account includes both general & vehicle insurance expenses. YTD is at 77% due to policy renewals occurring in July.

**Line 18 Utilities:** Utilities includes telephone expenses & electricity. YTD is trending on budget at 17%.

**Line 19 Operations & Maintenance:** O&M includes vehicle maintenance, vehicle fuel, mileage & travel reimbursement, uniforms, & equipment maintenance. Will trend under or over budget depending upon time of year expenses are incurred.

**Line 20 Permits & Fees:** This category includes the annual LAFCO fees, and the GFOA application fee for the budget award, and San Bernardino County Fees. YTD is at 73% due to July payment of LAFCO fees.

**Line 21 Office & Other Expense:** Office & Other Expenses include board meeting supplies, public relations, community promotion, bank charges, office supplies, postage and dues & subscription. YTD is at 25% due to timing of public noticing fees occurring in July.



# Helendale Community Services District

**DATE:** October 15, 2020  
**TO:** Board of Directors  
**FROM:** Kimberly Cox, General Manager  
**SUBJECT:** Agenda item #5  
Discussion Only Regarding COVID-19 Pandemic Update

## STAFF RECOMMENDATION:

Receive and file.

## STAFF REPORT:

San Bernardino County is hopeful to transition to the red category in the next few weeks. However, we had anticipated the transition occurring two weeks ago and that was not the case. Many counties around us have transitions towards full reopening as depicted on the map below.

### Statewide metrics

**7.1**  
New COVID-19 positive cases per day per 100K

**3.2%**  
Positivity rate

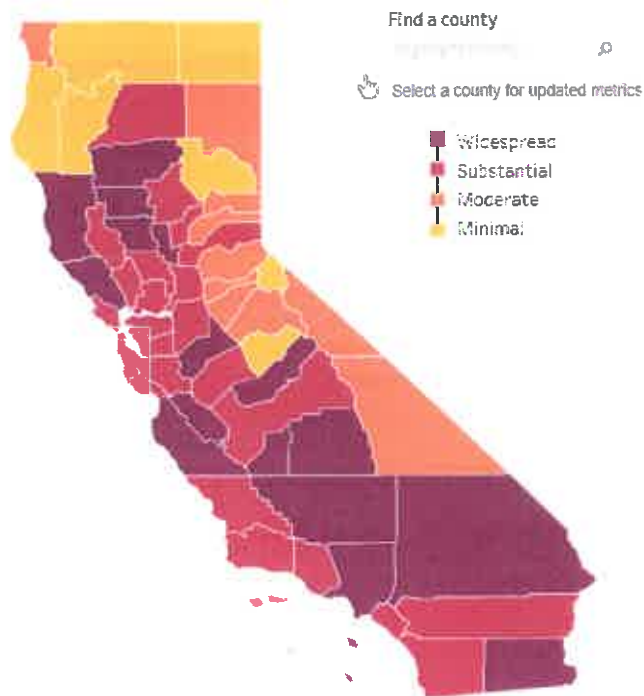

Current "adjusted case rate" for our county is 9.6. County's actual cases per day per 100k is 9.2. Positivity rate is 6.4%. The State issues is updated report every Tuesday. Additional information will be provided to the Board at the meeting on Thursday.

Staff continues to monitor the cash flow and the unpaid accounts as the prohibition for disconnections continues. Following is the most recent information as we transition into a new month with billing being sent out this week. The District transitioned over \$20,000 in old outstanding payments to the tax rolls thereby reducing the current amount in arrears to \$50,020 and increase from \$42,677.47 reported in August.

Lastly, the District continues to exercise precaution in daily operations with protocols in place to protect the staff and the public. With flu season approaching, there is heightened concern from the medical community regarding the combined impacts of the normal flu season and COVID-19.

**FISCAL IMPACT:** As outlined above.

**POSSIBLE MOTION:** None

**ATTACHMENTS:** None

# Helendale Community Services District

DATE: October 15, 2020  
TO: Board of Directors  
FROM: Kimberly Cox, General Manager  
SUBJECT: Agenda item #6  
Discussion Only Regarding Mandatory Testing Requirements for PFAS

---

## **STAFF RECOMMENDATION:**

None

## **STAFF REPORT:**

In 2019, Assembly Bill 756 was signed into law and amended the water code requiring water systems to be testing for “per and polyfluoroalkyl substances referred to as PFAS. The water system is not required to perform these related water quality tests, however, VVWRA, Cal Portland cement and CSA 42 in Oro Grande and City of Adelanto are all required to test for PFAS.

On July 9, 2020, the State Water Resources Control Board adopted Order WQ 2020-0015-DWQ which mandates that all wastewater facilities with a design of over 1million gallons per day are required to perform quarterly testing. Only certain laboratories are able to perform these tests and upon investigation, Staff has estimated that this will cost an additional \$36,000 from the wastewater budget for the one year of testing.

Staff is awaiting responses to emails sent to the state and more information will be forth coming.

**FISCAL IMPACT:** Approximately \$36,000

**POSSIBLE MOTION:**

**ATTACHMENTS:** Lighting layout

---

## State Water Resources Control Board

### WATER CODE SECTIONS 13267 AND 13383 ORDER FOR THE DETERMINATION OF THE PRESENCE OF PER- AND POLYFLUOROALKYL SUBSTANCES AT PUBLICLY OWNED TREATMENT WORKS

#### ORDER WQ 2020-0015-DWQ

Pursuant to Water Code sections 13267 and 13383, the State Water Resources Control Board (State Water Board) requires you to submit information as described herein. Failure to comply with this Order may subject you to civil liability of up to \$10,000 per day for each day in which the violation occurs.

Publicly owned treatment works (POTWs) are potentially significant receivers of per- and polyfluoroalkyl substances (PFAS) and have the potential to discharge these wastes to the environment. Potential discharges include, but are not limited to, wastewater effluent to surface waters and/or percolation basins, biosolids, and reverse osmosis concentrate/retentate from some treatment facilities. **Attachment 1** presents a conceptual model of PFAS emissions from a POTW (Interstate Technical Regulatory Council (ITRC), Per-and Polyfluoroalkyl Substances, March 2020). Your agency has been identified as owning or operating one or more POTWs in California that have a design capacity at or exceeding one million gallons per day (mgd), which is the scope of this Order. Additional orders may be issued in the future for facilities with less than an average dry weather design flow of 1 mgd capacity. **Attachment 2** presents a list of agencies and facilities required to comply with under this Order.

This Order requires completion of the following tasks:

1. Conduct sampling and analysis for each POTW listed in **Attachment 2** and submit the results of the sampling according to the requirements found in **Attachment 3**, Technical Sampling and Reporting Requirements.
2. Complete the questionnaire in **Attachment 3 (Sections C.3 and D)** for each of the POTWs listed in **Attachment 2**. The information required by the questionnaire shall be submitted electronically.



## I. FINDINGS

### A. WHAT ARE PFAS?

PFAS are a family of more than 5,000 man-made and mostly unregulated chemicals that have been produced since the mid-1900s. They are mobile, persistent, and bioaccumulative. They are resistant to degradation in the environment and when degradation occurs, it often results in the formation of other PFAS compounds. The PFAS compounds have very different physical and chemical properties. Currently, the key classes of concern are perfluoroalkyl sulfonic acids such as the long-chain perfluorooctanesulfonate (PFOS) and perfluorooctanoic acid (PFOA).

PFAS are manufactured globally and have been used in the production of a wide range of industrial and household products. Discharges to sewer systems from these sources, including disposal of landfill leachate and firefighting foam, results in PFAS in the influent to POTWs. Typical POTW treatment systems are not designed to remove PFAS. Therefore, the discharge from POTWs, especially those with industrial inputs, are possible contributors of PFAS to the environment. The Water Boards issued investigative Orders to airports, landfills, and plating shops pursuant to Water Code section 13267 to determine the presence of PFAS in wells proximal to those facilities. Those facilities can be contributors of PFAS to a POTW. (ITRC, History and Use of Per- and Polyfluoroalkyl Substances (PFAS) Fact Sheet, November 2017).

PFAS are also found in many products such as dental floss, non-stick cookware, food packaging materials, non-stick products (e.g., Teflon™), waterproof and water repellent textiles, water repellent furniture, carpet, polishes, waxes, paints, cleaning products, medical garments, and fire-fighting foams (aqueous film-forming foams; AFFF). PFAS are used in the aerospace, automotive, chemical, electronics, metal coatings and plating, and textiles industries due to their friction-reducing characteristics. PFAS have the potential to enter the waste stream from many different sources. Potential firefighting sources of PFAS include airports and aviation facilities, military bases and training centers, petroleum refineries and terminals, and petrochemical production facilities. Non-industrial PFAS sources include waste disposal facilities, wastewater treatment plant operations, and biosolids application to land. More information on PFAS chemicals can be found at the [United States Environmental Protection Agency \(U.S. EPA\) website \(www.epa.gov/pfas\)](https://www.epa.gov/pfas). Additional information about PFAS can be found at the State Water Board's PFAS website at <https://www.waterboards.ca.gov/pfas/>.

PFAS are extremely persistent in the environment and highly mobile in water. People can be exposed to PFAS through food, food packaging, consumer products, house dust, and drinking water. Since these chemicals have been used in an array of consumer products, scientists have found PFOA and PFOS and other PFAS compounds in the blood of nearly all people tested. Exposure through drinking water

has become an increasing concern due to the tendency of PFAS to accumulate in groundwater.

Based on current available peer-reviewed studies on laboratory animals and epidemiological evidence in human populations, the U.S. EPA released the following statement:

*“These studies indicate that exposure to PFOA and PFOS over certain levels may result in adverse health effects, including developmental effects to fetuses during pregnancy or to breastfed infants (e.g., low birth weight, accelerated puberty, skeletal variations), cancer (e.g., testicular, kidney), liver effects (e.g., tissue damage), immune effects (e.g., antibody production and immunity), thyroid effects and other effects (e.g., cholesterol changes).”*

Please see [U.S. EPA Technical Note](http://www.epa.gov/sites/production/files/2017-12/documents/ffrrofactsheet_contaminants_pfos_pfoa_11-20-17_508_0.pdf) ([www.epa.gov/sites/production/files/2017-12/documents/ffrrofactsheet\\_contaminants\\_pfos\\_pfoa\\_11-20-17\\_508\\_0.pdf](http://www.epa.gov/sites/production/files/2017-12/documents/ffrrofactsheet_contaminants_pfos_pfoa_11-20-17_508_0.pdf)) for more information.

#### **B. WHICH PFAS MUST BE ANALYZED?**

The Water Boards are concerned about all PFAS that exist in the environment. Due to analytical limitations, the focus of this Order is on 31 PFAS analytes listed in **Attachment 3**. The PFAS analyte list is not exhaustive but is intended to serve as a minimum requirement for sampling pursuant to this Order. Some laboratories may be capable of analyzing additional PFAS that are not included on the list.

#### **C. WHY IS THE WATER BOARD REQUIRING THIS SAMPLING AND ANALYSIS?**

The State Water Board and the Regional Water Boards are charged with the protection of the beneficial uses of water in California, including water used or that could potentially be used as drinking water. If PFAS-bearing wastes were discharged into the wastewater collection system, then it is likely that PFAS were discharged from the POTW in the effluent (including brine) and biosolids. The discharge of effluent may pose a threat to water quality if the effluent was discharged directly to surface waters or allowed to percolate to groundwater. PFAS in effluent discharges entering receiving waters also have the potential to bioaccumulate in aquatic food webs. Land application of biosolids may pose a threat to water quality by constituents percolating to groundwater or through water (such as irrigation water or storm water) carrying constituents to surface waters. The activities included in this Order are part of a statewide effort to 1) evaluate PFAS groundwater and surface water impacts and 2) conduct a preliminary investigation of the mass loading of PFAS into the POTW and then leaving the POTW in different media (treated wastewater, brine, biosolids). The State Water Board intends to direct other dischargers identified as potential PFAS sources in the state to perform PFAS testing. The State Water Board and the Regional Water Boards will evaluate the data collected to make informed decisions in implementing appropriate regulatory action.

**D. WHAT LEVELS ARE A PUBLIC HEALTH CONCERN?**

In May 2016, the U.S. EPA established drinking water Health Advisory Levels of 70 parts per trillion (ppt) (0.07 micrograms per liter (µg/L)) for PFOA and PFOS, individually or combined. These concentrations are now considered a preliminary remediation goal. The U.S. EPA *Draft Interim Recommendations to Address Groundwater Contaminated with Perfluorooctanoic Acid and Perfluorooctane Sulfonate* released in April 2019 suggested setting a remedial screening level at 40 ppt for PFOA and PFOS (individually). For more information on these advisories see the [U.S. EPA PFAS website](http://www.epa.gov/pfas) ([www.epa.gov/pfas](http://www.epa.gov/pfas)).

In August 2019, the State Water Board lowered the drinking water notification levels for PFOS and PFOA to 6.5 ppt and 5.1 ppt, respectively. In February 2020, the State Water Board lowered the response levels for PFOA and PFOS from 70 ppt combined to 10 ppt for PFOA and 40 ppt for PFOS based on a running four quarter average. More information on notification levels for PFAS compounds can be found on the State Water Board's Division of Drinking Water [PFOA and PFOS website](https://www.waterboards.ca.gov/drinking_water/certlic/drinkingwater/PFOA_PFOS.html) ([https://www.waterboards.ca.gov/drinking\\_water/certlic/drinkingwater/PFOA\\_PFOS.html](https://www.waterboards.ca.gov/drinking_water/certlic/drinkingwater/PFOA_PFOS.html)).

Water Code section 106.3 indicates it is the policy of the State of California that every human being has the right to safe, clean, affordable, and accessible water adequate for human consumption, cooking, and sanitary purposes. This Order promotes that policy by directing investigations to determine the presence of PFAS in and near waters that could be used for drinking water purposes.

**II. WATER CODE SECTIONS 13267 AND 13383 ORDER FOR TECHNICAL OR MONITORING REPORTS**

Water Code section 13267(b), authorizes the regional water boards to "require any person who has discharged, discharges, or is suspected of having discharged or discharging, or who proposes to discharge waste within its region... or is suspected of having discharged or discharging, or who proposes to discharge, waste outside of its region that could affect the quality of water within its region shall furnish, under penalty of perjury, technical or monitoring reports which the regional board requires... In requiring those reports, the regional board shall provide the person with a written explanation with regard to the need for the reports and shall identify the evidence that supports requiring that person to provide the reports."

Water Code section 13267(f) authorizes the State Water Board to require this information if it consults with the Regional Water Boards and determines that it will not duplicate the efforts of the Regional Water Boards. The State Water Board has consulted with the Regional Water Boards and made this determination.

Water Code section 13383(a) authorizes the Water Boards to "establish monitoring, inspection, entry, reporting, and recordkeeping requirements... for any person who discharges, or proposes to discharge, to navigable waters, any person who introduces pollutants into a publicly owned treatment works, any person who owns or operates, or proposes to own or operate, a publicly owned treatment works or other treatment works treating domestic sewage, or any person who uses or disposes, or proposes to use or dispose, of sewage sludge." Section 13383(b) continues, "the state board or the regional boards may require any person subject to this section to establish and maintain monitoring equipment or methods, including, where appropriate, biological monitoring methods, sample effluent as prescribed, and provide other information as may be reasonably required."

The release of PFAS into the environment or the disposal of wastes containing PFAS constitutes a discharge of waste as defined in Water Code section 13050(d). The discharge of wastewater containing PFAS to a sanitary sewer system constitutes the introduction of pollutants into a POTW as described in Water Code sections 13383 and 13373, and Clean Water Act section 502.

Pursuant to Water Code sections 13267 and 13383, **you are hereby ordered to submit the reports identified in Attachment 3.**<sup>1</sup> Additional information regarding requirements for submitting reports under these sections of the Water Code is included as **Attachment 4**. Any requests for extensions must be submitted to the Regional Water Board identified in the cover letter of this Order for approval by the Executive Officer.

### **III. COST AND BENEFIT OF TECHNICAL OR MONITORING REPORTS**

Water Code section 13267(b) specifies that the burden, including costs, of these reports must bear a reasonable relationship to the State Water Board's need for the reports and the benefits to be obtained from the reports. The total cost of conducting the sampling and preparing the reports required by this Order is estimated to be in the range of \$5,000 to \$25,000 for sampling and reporting.

The cost of the reports bears a reasonable relationship to the benefit to be gained because, in terms of public health and environmental harm, contamination of groundwater and surface water must be identified before corrective action can be taken, if appropriate. As described further in this Order and in **Attachment 3**, the recipients of this Order are likely discharging PFAS, which EPA has determined may cause adverse health effects.

---

<sup>1</sup> Monitoring and reporting for groundwater and discharges to land are required pursuant to Water Code section 13267. Monitoring and reporting for discharges to surface water are required pursuant to Water Code section 13383.

#### **IV. CALIFORNIA ENVIRONMENTAL QUALITY ACT**

The issuance of this Order is an action to protect the environment and is categorically exempt from the provisions of the California Environmental Quality Act pursuant to sections 15304 and 15308, Chapter 3, Title 14 of the California Code of Regulations.

#### **V. PENALTIES**

Water Code section 13268 provides that failure to submit the required groundwater monitoring/reporting information by the specified compliance date, or falsifying any information provided therein, is a misdemeanor and may subject you to administrative civil liability of up to \$5,000 for each day of violation.

Water Code section 13385 provides that failure to comply with surface water monitoring/reporting information may result in administrative civil liability of up to \$10,000 for each day of violation. Please be advised that compliance with this Order is not a substitute for compliance with other applicable laws.

Therefore, pursuant to Water Code sections 13267 and 13383, you are hereby ordered to:

1. Complete the questionnaire in **Attachment 3 (Sections C.3 and D)** for each of the POTWs listed in **Attachment 2** for which your agency is identified as the responsible agency. The questionnaire shall be completed by the responsible agency and submitted **no later than the submittal of the second quarter analytical results from the treatment system sampling**. The information required by the questionnaire shall be submitted electronically using the form accessed through Geotracker and required supplemental information should be submitted electronically in a pdf format to the same website as the questionnaire.
2. Conduct sampling and analysis for each POTW listed in **Attachment 2** for which your agency is identified as the responsible agency and submit sampling results according to the requirements found in **Attachment 3**, as outlined below.
  - For POTWs with an existing groundwater monitoring and reporting program under an order issued by the State or Regional Board, submit **within 60-days prior to conducting the first groundwater monitoring event** the rationale and location of proposed groundwater monitoring wells for a one-time sampling event (refer to **Attachment 3, Section 3.b** for specific details).

- Analytical results from the treatment system and groundwater sampling events shall be uploaded into the Water Board's GeoTracker system **within 30 days of receiving the laboratory analytical report.**
- One monitoring report summarizing the treatment system and groundwater monitoring shall be uploaded into the Water Board's GeoTracker system **no later than 60 days following the receipt of the last analytical laboratory report.**

### **Perjury Statement**

Pursuant to Water Code section 13267(b)(1), the State Water Board requires you to include the following perjury statement, signed by a duly authorized representative, in all reports submitted pursuant to this Order:

"I, Eileen Sobeck, certify under penalty of law that this document and all attachments were prepared by me, or under my direction or supervision, and the information submitted is, to the best of my knowledge and belief, true, accurate, and complete. I am aware that there are significant civil penalties for submitting false information."

July 9, 2020

Date



**EILEEN SOBECK**, Executive Director

### **ATTACHMENTS:**

**Attachment 1 – Conceptual Site Model for Per and Polyfluoroalkyl Substances at POTWs**

**Attachment 2 – List of Facilities**

**Attachment 3 - Technical Sampling and Reporting Requirements**

**Attachment 4 – Fact Sheet – Requirements for Submitting Reports under Section 13267 and 13383 of the Water Code**

# ATTACHMENT 1

## Conceptual Site Model for Per and Polyfluorakyl Substances at POTWs

WATER CODE SECTION 13267/13383 ORDER FOR THE  
DETERMINATION OF THE PRESENCE OF PER- AND POLYFLUOROALKYL SUBSTANCES



**KEY**  $\blacktriangle$  Atmospheric Deposition  $\circ$  Diffusion/Dispersion/Advection  $\blacksquare$  Infiltration  $\bullet$  Transformation of precursors (abiotic/biotic)

From Interstate Technical Regulatory Council, Per-and Polyfluoroalkyl Substances, March 2020



**ATTACHMENT 2 - LIST OF FACILITIES**  
**WATER CODE SECTION 13267/13383 ORDER FOR THE**  
**DETERMINATION OF THE PRESENCE OF PER-AND POLYFLUOROALKYL SUBSTANCES AT PUBLICLY OWNED TREATMENT WORKS (POTWS)**

Facility ID	Region #	Regional Board	Facility Name	Agency Name	Address	City	Zip	County	Reg Measure ID	WDID	GeoTracker Global ID	Design Flow MGD
255703	1	North Coast	Santa Rosa Laguna Subregional WRF	Santa Rosa City Dept of Public Works	4300 Llano Road	Santa Rosa	95407	Sonoma	378138	1B883099OSON	NPD100051903	21.34
229922	1	North Coast	Healdsburg City WWTP	Healdsburg City	340 Foreman Lane	Healdsburg	95448	Sonoma	399916	1B882046OSON	NPD100051474	1.4
240093	1	North Coast	McKinleyville WWTP	McKinleyville CSD	675 Hiller Road	McKinleyville	95521	Humboldt	402457	1B882084OHUM	NPD100051511	1.61
225055	1	North Coast	Fort Bragg City WWTP	Fort Bragg City	281 Jere Melo Street	Fort Bragg	95437	Mendocino	430202	1B884083OMEN	NPD100051533	1
268960	1	North Coast	Ukiah City WWTP	Ukiah City	300 Treatment Plant Road	Ukiah	95482	Mendocino	413425	1B884029OMEN	NPD100051538	3.01
272790	1	North Coast	Windsor Town WWTP	Windsor Water District	8400 Windsor Road	Windsor	95492	Sonoma	382410	1B882037OSON	NPD100051545	2.25
216106	1	North Coast	Crescent City WWTP	Crescent City	210 Battery Street	Crescent City	95531	Del Norte	404228	1A84006ODN	NPD100051548	1.86
206164	1	North Coast	Arcata City WWTF	Arcata City	600 South G Street	Arcata	95521	Humboldt	321411	1B882114OHUM	NPD100051550	2.3
272646	1	North Coast	Willits City WWTP	Willits City	300 North Lenore Street	Willits	95490	Mendocino	400116	1B88078OMEN	NPD100051569	1.3
214888	1	North Coast	Cloverdale City WWTP	Cloverdale City	700 Asti Road	Cloverdale	95425	Sonoma	425653	1B884032OSON	NPD100051574	1
225089	1	North Coast	Fortuna City WWTP	Fortuna City	180 Dinsmore	Fortuna	95540	Humboldt	401784	1B883135OHUM	WDR100028457	1.5
223010	1	North Coast	Eureka City Elk River WWTP	Eureka City	4301 Hilliker Lane	Eureka	95501	Humboldt	405560	1B882151OHUM	WDR100028634	5.24
274538	1	North Coast	Yreka City WWTP	Yreka City	856 North Main Street	Yreka	96897	Siskiyou	132393	1A84073OSIS	WDR100036290	1.4
212858	3	Central Coast	Cambria Community Services District WWTP	Cambria Community Services District	1316 Tamsom Dr, Ste 201	Cambria	93428	San Luis Obispo	131132	3 400102001	WDR100029268	1.5
248519	3	Central Coast	Pismo Beach WWTP	Pismo Beach City	550 Frady Ln	Pismo Beach	93449	San Luis Obispo	403753	3 400106001	NPD100051481	1.9
213281	3	Central Coast	Carmel Area WWTP	Carmel Area Wastewater District	3945 Rio Road	Carmel	93922	Monterey	396646	3 270101001	NPD100051489	3
237315	3	Central Coast	Lompoc Regional WRP	Lompoc City	West 1801 Central Avenue	Lompoc	93436	Santa Barbara	383021	3 420105001	NPD100051494	5
241740	3	Central Coast	Monterey One Water Regional WWTP	Monterey One Water	14811 Del Monte Boulevard	Marina	93933	Monterey	429636	3 270118002	NPD100051504	29.6
257887	3	Central Coast	South San Luis Obispo SD WWTP	South San Luis Obispo CSD	1600 Aloha Place	Oceano	93445	San Luis Obispo	430003	3 400111001	NPD100051517	3.3
213332	3	Central Coast	Carpinteria SD WWTP	Carpinteria SD	5351 Sixth Street	Carpinteria	93013	Santa Barbara	418040	3 420101001	NPD100051525	2
241479	3	Central Coast	Morro Bay/Cayucos WWTP	Morro Bay SD	160 Atascadero Road	Morro Bay	93442	San Luis Obispo	418033	3 400103001	NPD100051541	2.36
256011	3	Central Coast	Scotts Valley WWTP	Scotts Valley City	700 Lundy Lane	Scotts Valley	95066	Santa Cruz	389665	3 440103001	NPD100051555	1.5
241288	3	Central Coast	Montecito SD WWTP	Montecito Sanitary District	1042 Monte Cristo Lane	Santa Barbara	93108	Santa Barbara	388741	3 420107001	NPD100051564	1.5



**ATTACHMENT 2 - LIST OF FACILITIES**  
**WATER CODE SECTION 13267/13383 ORDER FOR THE**  
**DETERMINATION OF THE PRESENCE OF PER-AND POLYFLUOROALKYL SUBSTANCES AT PUBLICLY OWNED TREATMENT WORKS (POTWS)**

Facility ID	Region #	Regional Board	Facility Name	Agency Name	Address	City	Zip	County	Reg Measure ID	WDID	GeoTracker Global ID	Design Flow MGD
247750	3	Central Coast	Paso Robles WWTP	City of El Paso de Robles	3400 Sulphur Springs Rd	Paso Robles	93446	San Luis Obispo	379360	3 400105001	NPD100051576	4.9
255380	3	Central Coast	San Luis Obispo WWTP	San Luis Obispo City	35 Prado Road	San Luis Obispo	93401	San Luis Obispo	399576	3 400107001	NPD100051582	5.1
227568	3	Central Coast	Goleta SD WWTP	Goleta SD	1 Moffett Place	Goleta	93117	Santa Barbara	418037	3 420102001	NPD100051597	7.64
271872	3	Central Coast	Watsonville WWTP	Watsonville City	401 Panabaker Lane	Watsonville	95077	Santa Cruz	396491	3 440104001	NPD100051609	12
222443	3	Central Coast	El Estero Water Resource Center NPDES	Santa Barbara City PWD	520 East Yanonail Street	Santa Barbara	93103	Santa Barbara	374330	3 420108001	NPD100051624	11
255632	3	Central Coast	Santa Cruz WWTP	Santa Cruz City	110 California Street	Santa Cruz	95060	Santa Cruz	418035	3 440102001	NPD100051630	17
206653	3	Central Coast	Atascadero WWTP	Atascadero City	8005 Gabarda	Atascadero	93422	San Luis Obispo	142083	3 400100001	WDR100026749	2.39
255678	3	Central Coast	City of Santa Maria WWTP	City of Santa Maria	601 Black Road	Santa Maria	93458	Santa Barbara	373327	3 420109001	WDR100029526	9.5
235021	3	Central Coast	King City Domestic WWTF	King City	212 South Vanderhurst Ave	Salinas	93930	Monterey	144671	3 270106001	WDR100030085	1.2
236124	3	Central Coast	Laguna County Sanitation District WWRf	Laguna Sanitation	620 West Foster Rd	Santa Maria	93455	Santa Barbara	383007	3 420104001	WDR100030531	3.7
227893	3	Central Coast	City of Greenfield WWTP	Greenfield City	599 El Camino Real	Greenfield	93960	Monterey	131446	3 270105001	WDR100031387	1
230555	3	Central Coast	Hollister Domestic WWTP	Hollister City	2690 San Juan Road	Hollister	95023	San Benito	359247	3 350100001	WDR100031912	4.5
227602	3	Central Coast	City of Gonzales WWTP	Gonzales City	P.O. Box 647, 147 Fourth Street	Gonzales	93926	Monterey	302168	3 270104001	WDR100032021	1.3
731257	3	Central Coast	Pajaro Valley WMA and City of Watsonville WRF	Pajaro Valley Water Management Agency	401 Panabaker Lane	Watsonville	95076	Santa Cruz	359226	3 441208240	WDR100032411	7.7
256483	3	Central Coast	Soledad Sewage Treatment Plant	Soledad City	34520 Morisoli Rd	Soledad	93960	Monterey	349587	3 270113001	WDR100034559	5.5
257687	3	Central Coast	Solvang WWTP	Solvang City	1644 Oak Street	Solvang	93463	Santa Barbara	336192	3 420110001	WDR100034624	1.5
256039	3	Central Coast	SCRWA WWTP	South County Regional WW Authority	900 Southside Dr	Gilroy	95020	Santa Clara	418038	3 430100001	WDR100034880	7.5
222442	3	Central Coast	El Estero Reclamation Facility	Santa Barbara City PWD	402 East Mason St	Santa Barbara	93101	Santa Barbara	147037	3 420108005	WDR100035708	1.6
822816	3	Central Coast	Los Osos Water Recycling Facility	San Luis Obispo CSA #9 Los Osos WTP	2300 Los Osos Valley Road	Los Osos	93402	San Luis Obispo	379559	3 400910371	WDR100039574	1.2
650554	4	Los Angeles	Santa Paula WRF	Santa Paula City	920 Corporation Street	Santa Paula	93060	Ventura	403136	4A560108002	WDR100000849	4.2
231693	4	Los Angeles	Hill Canyon WWTP	Thousand Oaks City	9600 Santa Rosa Road	Camarillo	93012	Ventura	395353	4A560112001	NPD100051993	14

**ATTACHMENT 2 - LIST OF FACILITIES**  
**WATER CODE SECTION 13267/13383 ORDER FOR THE**  
**DETERMINATION OF THE PRESENCE OF PER-AND POLYFLUOROALKYL SUBSTANCES AT PUBLICLY OWNED TREATMENT WORKS (POTWs)**

Facility ID	Region #	Regional Board	Facility Name	Agency Name	Address	City	Zip	County	Reg Measure ID	WDID	GeoTracker Global ID	Design Flow MGD
271054	4	Los Angeles	Ventura WRF	Ventura City	1400 Spinnaker Drive	Ventura	93002	Ventura	387812	4A560107001	WDR100000656	14
267130	4	Los Angeles	Terminal Island Water Reclamation Plant	Los Angeles City Bureau of Sanitation	445 Ferry Street	San Pedro	90731	Los Angeles	399400	4B190106005	NPD100051952	30
246616	4	Los Angeles	Ojai Valley WWTP	Ojai Valley Sanitary District	6363 North Ventura Avenue	Ventura	93001	Ventura	424638	4A560104001	NPD100051520	3
208276	4	Los Angeles	Avalon WWTF	Avalon City	123 Peppy Beach Road	Avalon	90704	Los Angeles	424707	4B190100001	NPD100051640	1.2
234156	4	Los Angeles	Joint Water Pollution Control Plant	County Sanitation Districts of Los Angeles County	24501 South Figueroa Street	Carson	90745	Los Angeles	416544	4B190107013	NPD100051648	400
212135	4	Los Angeles	Burbank WRP	Burbank City DPW	740 North Lake Street	Burbank	91502	Los Angeles	403428	4B190101001	WDR100000132	12.5
216832	4	Los Angeles	Camrosa Water Reclamation Facility	Camrosa Water District	1900 South Lewis Road	Camarillo	93012	Ventura	400018	4A560106003	WDR100000191	1.5
246946	4	Los Angeles	Oxnard Wastewater Treatment Plant	Oxnard City Wastewater Division	6001 Perkins Rd	Oxnard	93033	Ventura	369637	4A560105001	WDR100000408	31.7
261253	4	Los Angeles	Simi Valley WQCP	Simi Valley City	600 West Los Angeles Avenue	Simi Valley	93065	Ventura	133824	4A560110001	WDR100000869	12.5
266940	4	Los Angeles	Tapia WRF	Las Virgenes MWD	731 Malibu Canyon Road	Calabasas	91302	Los Angeles	135049	4B190104001	WDR100001039	12
260156	4	Los Angeles	San Jose Creek Water Reclamation Plant	County Sanitation Districts of Los Angeles County	1965 South Workman Mill Road	Whittier	90601	Los Angeles	133828	4B190107020	WDR100001083	100
260494	4	Los Angeles	Saugus Water Reclamation Plant	Santa Clarita Valley SD of Los Angeles Cnty	26200 Springbrook Avenue	Santa Clarita	91350	Los Angeles	133827	4A190107021	WDR100001085	6.5
270849	4	Los Angeles	Valencia WRP	Santa Clarita Valley SD of Los Angeles Cnty	28185 The Old Road	Valencia	91355	Los Angeles	133826	4A190107023	WDR100001103	21.6
267571	4	Los Angeles	Donald C. Tillman WWRP	Los Angeles City Bureau of Sanitation	6100 Woodley Avenue	Van Nuys	91406	Los Angeles	323039, 412169	4B190106004	WDR100001153	80
232063	4	Los Angeles	Hyperion WWTP	Los Angeles City Bureau of Sanitation	12000 Vista del Mar Boulevard	Playa del Rey	90293	Los Angeles	384801	4B190106002	WDR100001158	450
235738	4	Los Angeles	Los Angeles - Glendale WWRP	Los Angeles City Bureau of Sanitation	4600 Colorado Boulevard	Los Angeles	90039	Los Angeles	323041	4B190106001	WDR100001164	20
243377	4	Los Angeles	Moorpark WWTP - WRR	Ventura County Special Districts	9550 Los Angeles Avenue	Moorpark	93021	Ventura	131554	4A560103003	WDR100001453	1.5
225881	4	Los Angeles	Fillmore WWTP and Wastewater Recycling Plant	Fillmore City	250 Central Avenue	Fillmore	93015	Ventura	417130	4A560101001	WDR100001584	1.33
235826	4	Los Angeles	Whittier Narrows Water Reclamation Plant	County Sanitation Districts of Los Angeles County	301 North Rosemead Boulevard	El Monte	91733	Los Angeles	408201	4B190107016	WDR100001741	15

**ATTACHMENT 2 - LIST OF FACILITIES**  
**WATER CODE SECTION 13267/13383 ORDER FOR THE**  
**DETERMINATION OF THE PRESENCE OF PER-AND POLYFLUOROALKYL SUBSTANCES AT PUBLICLY OWNED TREATMENT WORKS (POTWS)**

Facility ID	Region #	Regional Board	Facility Name	Agency Name	Address	City	Zip	County	Reg Measure ID	WDID	GeoTracker Global ID	Design Flow MGD
238562	4	Los Angeles	Long Beach WRP	County Sanitation Districts of Los Angeles County	7400 East Willow Street	Long Beach	90815	Los Angeles	133825	4B190107014	WDR100001744	25
238646	4	Los Angeles	Los Coyotes WRP	County Sanitation Districts of Los Angeles County	16515 Pluma Avenue	Cerritos	90703	Los Angeles	133829	4B190107015	WDR100001745	37.5
250700	4	Los Angeles	Pomona Water Reclamation Plant	County Sanitation Districts of Los Angeles County	295 Humane Way	Pomona	91766	Los Angeles	134831	4B190107019	WDR100001746	15
216719	4	Los Angeles	Camarillo WRP	Camarillo Sanitary District	150 East Howard Road	Camarillo	93012	Ventura	393691	4A560100001	WDR100014340	7.25
273142	5F	Central Valley (Fresno)	Kern Sanitation Authority	Kern Sanitation Authority	4101 Kimber Ave	Bakersfield	93307	Kern	144791	5D150105001	WDR100030946	7
273143	5F	Central Valley (Fresno)	North of River WWTF	North of River SD #1	28970 7th Standard Road	Shafter	93264	Kern	333653	5C15NC00090	WDR100032991	7.5
214899	5F	Central Valley (Fresno)	Clovis WWTF	Clovis City	9700 East Ashlan Avenue	Clovis	93619	Fresno	429278	5C10NP00012	NPD100051487	2.8
214652	5F	Central Valley (Fresno)	Merced WWTF	Merced City	10260 Gove Road	Merced	95340	Merced	397512	5C240108001	NPD100051529	12
222491	5F	Central Valley (Fresno)	EI Portal WWTF	USDI National Park Service Yosemite National Park	5083 Foresta Road, #BLDG 750	EI Portal	95318	Mariposa	434880	5C220701002	NPD100051602	1
273166	5F	Central Valley (Fresno)	Cutter-Orosi WWTF	Cutter-Orosi JT Powers WW Authority	40401 Road 120	Cutter	93615	Tulare	420796	5D540132001	NPD100051611	1.5
747519	5F	Central Valley (Fresno)	Atwater Regional WWTF	Atwater City	530 South Bert Crane Road	Atwater	95340	Merced	422026	5B24NP00017	WDR100028784	6
273104	5F	Central Valley (Fresno)	Arvin WWTF	Arvin City	2401 El Camino Real	Arvin	93203	Kern	147823	5D150107001	WDR100028819	1.45
273208	5F	Central Valley (Fresno)	Bakersfield WWTP #2	Bakersfield City	1700 E Planz Road	Bakersfield	93307	Kern	332777	5D150100001	WDR100027078	25
273209	5F	Central Valley (Fresno)	Bakersfield WWTP #3	Bakersfield City	6901 McCutchen Road	Bakersfield	93313	Kern	343591	5D150100002	WDR100027080	16
273160	5F	Central Valley (Fresno)	Avenal WWTF	Avenal City	1 Effluent Wy	Avenal	93204	Kings	142310	5D160101001	WDR100027879	1
273115	5F	Central Valley (Fresno)	Fresno Regional WWTF	Fresno City Department of Public Utilities	5607 W Jensen Ave	Fresno	93706	Fresno	427699	5D100105001	WDR100028344	88
273109	5F	Central Valley (Fresno)	Delano WWTF	Delano City	1107 Lytle Ave	Delano	93215	Kern	375255	5D150102001	WDR100028422	7.2
273112	5F	Central Valley (Fresno)	Exeter WWTF	Exeter City	1906 West Meyers	Exeter	93221	Tulare	131464	5D540103001	WDR100028696	1.07
273110	5F	Central Valley (Fresno)	Dinuba WWTF	Dinuba City	6675 Ave 412	Dinuba	93618	Tulare	145349	5D540101001	WDR100028781	3

**ATTACHMENT 2 - LIST OF FACILITIES**  
**WATER CODE SECTION 13267/13383 ORDER FOR THE**  
**DETERMINATION OF THE PRESENCE OF PER-AND POLYFLUOROALKYL SUBSTANCES AT PUBLICLY OWNED TREATMENT WORKS (POTWs)**

Facility ID	Region #	Regional Board	Facility Name	Agency Name	Address	City	Zip	County	Reg Measure ID	WDID	GeoTracker Global ID	Design Flow MGD
273113	5F	Central Valley (Fresno)	Farmersville WWTF	Farmersville City	909 W Visalia Rd	Farmersville	93223	Tulare	144651	5D540117001	WDR100029004	1.25
273106	5F	Central Valley (Fresno)	Chowchilla WWTF	Chowchilla City	130 S Second Street	Chowchilla	93610	Madera	144724	5C200100001	WDR100029289	2
273108	5F	Central Valley (Fresno)	Corcoran WWTF	Corcoran City	832 Whitley Avenue	Corcoran	93212	Kings	144786	5D160102001	WDR100029670	1.45
233460	5F	Central Valley (Fresno)	Jamestown Sanitary District WWTF	Jamestown SD	17600 Highway 108	Jamestown	95327	Tuolumne	142343	5C550101001	WDR100030064	1.01
273174	5F	Central Valley (Fresno)	Lamont WWTF	Lamont PUD	6525 East Bear Mountain Road	Lamont	93307	Kern	385516	5D150108001	WDR100030159	2
273123	5F	Central Valley (Fresno)	Madera WWTF	Madera City	13048 Rd 21 1/2	Madera	93637	Madera	145289	5C200101001	WDR100030305	7
201068	5F	Central Valley (Fresno)	Madera County #2 - Bass Lake WWTF	Madera County Public Works Department - Special Districts	40601 Rd 274	Bass Lake	93604	Madera	142311	5C200102001	WDR100030311	1
234841	5F	Central Valley (Fresno)	Kerman WWTF	Kerman City	15485 W. Church Ave	Kerman	93630	Fresno	331380	5D100108001	WDR100030774	1.2
273121	5F	Central Valley (Fresno)	Lindsay WWTF	Lindsay City	23611 Road 196	Lindsay	93247	Tulare	145554	5D540105001	WDR100030805	1.24
273122	5F	Central Valley (Fresno)	Los Banos WWTF	Los Banos City	411 Madison Ave	Los Banos	93635	Merced	145424	5C240107001	WDR100030875	4.9
220469	5F	Central Valley (Fresno)	Livingston Domestic WWTF	Livingston City	7160 North Gallo Road	Livingston	95334	Merced	331392	5C240106002	WDR100030927	1.18
273119	5F	Central Valley (Fresno)	Huron WWTF	Huron City	P.O. Box 339, 36311 S Lassen Ave	Huron	93234	Fresno	328068	5D100107001	WDR100031282	1
273116	5F	Central Valley (Fresno)	Gustine WWTF	Gustine City	26501 Camation Road	Gustine	95322	Merced	145495	5C240103002	WDR100031700	1.4
273118	5F	Central Valley (Fresno)	Hanford WWTF	Hanford City	10555 Houston	Hanford	93230	Kings	148388	5D160103001	WDR100031904	8
273127	5F	Central Valley (Fresno)	Orange Cove WWTF	Orange Cove City	633 Sixth Street	Orange Cove	93646	Fresno	132495	5D100110001	WDR100032590	1
273128	5F	Central Valley (Fresno)	Parlier WWTF	Parlier City	1101 East Parlier Avenue	Parlier	93648	Fresno	145326	5D100118001	WDR100032734	2
273130	5F	Central Valley (Fresno)	Porterville WWTF	Porterville City	555 Prospect	Porterville	93257	Tulare	344805	5D540107001	WDR100032998	8
273125	5F	Central Valley (Fresno)	McFarland WWTF	McFarland City	401 W. Kern Ave	McFarland	93250	Kern	330608	5D150109001	WDR100033647	1.55
273126	5F	Central Valley (Fresno)	Mendota WWTF	Mendota City	643 Quince Street	Mendota	93640	Fresno	330730	5D100109001	WDR100033840	1.28
214665	5F	Central Valley (Fresno)	Taft WWTF	Taft City	1120 E Ash Street	Taft	93268	Kern	351981	5C15NC00095	WDR100034221	1.5

**ATTACHMENT 2 - LIST OF FACILITIES**  
**WATER CODE SECTION 13267/13383 ORDER FOR THE**  
**DETERMINATION OF THE PRESENCE OF PER-AND POLYFLUOROALKYL SUBSTANCES AT PUBLICLY OWNED TREATMENT WORKS (POTWS)**

Facility ID	Region #	Regional Board	Facility Name	Agency Name	Address	City	Zip	County	Reg Measure ID	WDID	GeoTracker Global ID	Design Flow MGD
817457	5F	Central Valley (Fresno)	Tesoro Viejo Wastewater Treatment Plant	Tesoro Viejo Master Mutual Water Company	2042 Second Street	Madera	93636	Madera	402537	5B20NC00105	WDR100034356	1
273133	5F	Central Valley (Fresno)	Sanger WWTF	Sanger City	1700 7th Street	Sanger	93657	Fresno	394866	5D100115001	WDR100035646	2.9
273187	5F	Central Valley (Fresno)	Selma-Kingsburg-Fowler CSD WWTF	Selma-Kings-Fowler CSD	11301 East Conejo Ave	Kingsburg	93631	Fresno	131438	5D100104001	WDR100035855	8
273131	5F	Central Valley (Fresno)	Reedley WWTF	Reedley City	1701 West Huntsman	Reedley	93654	Fresno	333271	5C10NC00167	WDR100036052	5
273140	5F	Central Valley (Fresno)	Woodlake WWTF	Woodlake City	811 South Valencia Boulevard	Woodlake	93286	Tulare	371066	5D540114001	WDR100036650	1.38
273196	5F	Central Valley (Fresno)	Wasco WWTF	Wasco City	746 8th Street	Wasco	93280	Kern	131603	5D150117001	WDR100036562	1.95
273138	5F	Central Valley (Fresno)	Visalia WWTF	Visalia City	7579 Ave 288	Visalia	93277	Tulare	409518	5D540113001	WDR100036941	18
273137	5F	Central Valley (Fresno)	Tulare WWTF	Tulare City	1875 South West Street	Tulare	93274	Tulare	367947	5D540110001	WDR100037264	16
257763	5F	Central Valley (Fresno)	Sonora Regional WWTF	Tuolumne Utilities District	1400 Southgate	Sonora	95370	Tuolumne	141783	5C550106004	WDR100037396	2.6
273180	5F	Central Valley (Fresno)	Malaga CWD WWTF	Malaga CWD	3601 S Maple Ave	Fresno	93725	Fresno	387532	5D100124001	WDR100047360	1.2
246203	5R	Central Valley (Redding)	Orland WWTP	Orland City	6917 Co Rd 200	Orland	95963	Glenn	350817	5A110100001	NPD100051994	2.1
214802	5R	Central Valley (Redding)	Clear Creek WWTP	Redding City	2220 Metz Road	Anderson	96007	Shasta	412195	5A450103001	NPD100051480	8.8
246251	5R	Central Valley (Redding)	Sewerage Commission Oroville Region WWTP	Sewerage Commission Oroville Region	2880 South 5th Avenue	Oroville	95965	Butte	397468	5A040106001	NPD100051498	6.5
215750	5R	Central Valley (Redding)	City of Corning WWTP	Corning City	25010 Gardiner Ferry Road	Corning	96021	Tehama	399898	5A520100001	NPD100051506	1.4
252119	5R	Central Valley (Redding)	Red Bluff WW Reclamation Plant	Red Bluff City	700 Messer Drive	Red Bluff	96080	Tehama	421692	5A520101001	NPD100051519	2.5
256627	5R	Central Valley (Redding)	Shasta Lake WWTF	Shasta Lake City	3700 Tibbitts Road	Shasta Lake	96019	Shasta	395785	5A450105001	NPD100051534	1.3
271805	5R	Central Valley (Redding)	Chico Water Pollution Control Plant	Chico City	4827 Chico River Road	Chico	95927	Butte	397469	5A040102001	NPD100051547	12
256676	5R	Central Valley (Redding)	Stillwater WWTF	Redding City	6475 Airport Road	Anderson	96007	Shasta	422002	5A450103004	NPD100051563	3.4
205741	5R	Central Valley (Redding)	Anderson WPCP	Anderson City	3701 Rupert Road	Anderson	96007	Shasta	429568	5A450100001	NPD100051592	2
272704	5R	Central Valley (Redding)	Willows Wastewater Treatment Plant	Willows City	1600 South Tehama	Willows	95988	Glenn	410961	5A110101001	NPD100051605	1.2

**ATTACHMENT 2 - LIST OF FACILITIES**  
**WATER CODE SECTION 13267/13383 ORDER FOR THE**  
**DETERMINATION OF THE PRESENCE OF PER-AND POLYFLUOROALKYL SUBSTANCES AT PUBLICLY OWNED TREATMENT WORKS (POTWs)**

Facility ID	Region #	Regional Board	Facility Name	Agency Name	Address	City	Zip	County	Reg Measure ID	WDID	GeoTracker Global ID	Design Flow MGD
846487	5R	Central Valley (Redding)	American Valley WWTP	American Valley CSD	900 Spanish Creek Road	Quincy	95871	Plumas	407661	5A320103001	NPD100051644	1.6
254981	5S	Central Valley (Sacramento)	Sacramento Regional WWTP	Sacramento Regional CSD	8521 Laguna Station Road	Elk Grove	95758	Sacramento	405960	5A340108002	NPD100051477	181
215236	5S	Central Valley (Sacramento)	Sac City Combined WW Collection/TRT Sys	Sacramento City	1395 35th Avenue	Sacramento	95822	Sacramento	400866	5A340114001	NPD100051478	48.18
219223	5S	Central Valley (Sacramento)	City of Davis WWTP	Davis City	45400 County Road 28H	Davis	95776	Yolo	428211	5A570100001	NPD100051486	7.5
214647	5S	Central Valley (Sacramento)	Live Oak City WWTP	Live Oak City	3450 Treatment Road	Live Oak	95953	Sutter	407656	5A510100001	NPD100051495	1.4
220315	5S	Central Valley (Sacramento)	Discovery Bay WWTP	Town of Discovery Bay CSD	1800 Willow Lake Road	Discovery Bay	94514	Contra Costa	396976	5B070105003	NPD100051501	2.1
268926	5S	Central Valley (Sacramento)	UC Davis Main WWTP	UC Davis	1140 Old Davis Road	Davis	95620	Solano	399193	5A570800001	NPD100051502	3.6
241146	5S	Central Valley (Sacramento)	City of Modesto WQCF	Modesto City	1221 Sutter Avenue	Modesto	95351	Stanislaus	413899	5C500102001	NPD100051510	14.9
206733	5S	Central Valley (Sacramento)	Auburn WWTP	Auburn City	10441 Ophir Road	Auburn	95603	Placer	407662	5A31NP00042	NPD100051528	1.67
266439	5S	Central Valley (Sacramento)	Northwest WWTF	Rio Vista City	3000 Airport Road	Rio Vista	94571	Solano	404089	5A480108001	NPD100051536	1
229595	5S	Central Valley (Sacramento)	Hangtown Creek WRF	Placerville City	2300 Coolwater Creek Road	Placerville	95667	El Dorado	395004	5A090100001	NPD100051540	2.3
258739	5S	Central Valley (Sacramento)	Stockton Regional WW Control Facility	Stockton City	2500 Navy Drive	Stockton	95206	San Joaquin	396967	5B390107001	NPD100051560	55
227818	5S	Central Valley (Sacramento)	Grass Valley City WWTP	Grass Valley City	556 C Freeman Lane	Grass Valley	95949	Nevada	405024	5A290100001	NPD100051580	2.78
266737	5S	Central Valley (Sacramento)	Turlock Regional Water Quality Control Facility	Turlock City	901 South Walnut Road	Turlock	95380	Stanislaus	400734	5C500108001	NPD100051583	20
248706	5S	Central Valley (Sacramento)	Pleasant Grove WWTP	Roseville City	5051 Westpark Drive	Roseville	95747	Placer	432817	5A310106007	NPD100051587	12
245949	5S	Central Valley (Sacramento)	Olivehurst WWTP	Olivehurst PUD	3908 Mary Avenue	Olivehurst	95961	Yuba	405016	5A580102001	NPD100051589	3
210322	5S	Central Valley (Sacramento)	Brentwood WWTP	Brentwood City	2251 Elkins Way	Brentwood	94513	Contra Costa	430031	5B070101001	NPD100051591	5
274556	5S	Central Valley (Sacramento)	Yuba City WWTF	Yuba City	302 Burns Drive	Yuba City	95991	Sutter	428768	5A510101001	NPD100051606	10.5
222057	5S	Central Valley (Sacramento)	Easterly WWTP	Vacaville City DPW	6040 Vaca Station Road	Elmira	95687	Solano	433231	5A480105002	NPD100051608	15
219398	5S	Central Valley (Sacramento)	Deer Creek WWTP	El Dorado Irrigation District	1565 Deer Creek Road	Cameron Park	95682	El Dorado	433255	5B090102001	NPD100051610	3.6
237060	5S	Central Valley (Sacramento)	Linda County Water District WWTP	Linda City Water District	909 Myrna Avenue	Marysville	95901	Yuba	415997	5A580100002	NPD100051617	5

**ATTACHMENT 2 - LIST OF FACILITIES**  
**WATER CODE SECTION 13267/13383 ORDER FOR THE**  
**DETERMINATION OF THE PRESENCE OF PER-AND POLYFLUOROALKYL SUBSTANCES AT PUBLICLY OWNED TREATMENT WORKS (POTWs)**

Facility ID	Region #	Regional Board	Facility Name	Agency Name	Address	City	Zip	County	Reg Measure ID	WDID	GeoTracker Global ID	Design Flow MGD
222434	5S	Central Valley (Sacramento)	El Dorado Hills WWTP	El Dorado Irrigation District	4625 Latrobe Road	El Dorado Hills	95762	El Dorado	425238	5B090102005	NPD100051618	4
255180	5S	Central Valley (Sacramento)	San Andreas SD WWTP	San Andreas SD	675 Gold Oak Road	San Andreas	95249	Calaveras	425799	5B050103001	NPD100051626	1.5
222916	5S	Central Valley (Sacramento)	Escalon Treatment Plant	Escalon City	25100 West River Road	Escalon	95320	San Joaquin	140412	5B390101001	WDR100028561	3.4
220396	5S	Central Valley (Sacramento)	Dixon WWTF	Dixon City PWD	6915 Pedrick Road	Dixon	95620	Solano	394601	5A480101001	WDR100028790	1.92
214812	5S	Central Valley (Sacramento)	Clearlake Oaks Co WTR Dis WWTP	Clearlake Oaks Cnty Water Dist	13705 Jensen Road	Clearlake Oaks	95423	Lake	147062	5A170100002	WDR100029656	2.1
213947	5S	Central Valley (Sacramento)	Ceres WWTP	Ceres City	4200 Morgan	Ceres	95307	Stanislaus	141185	5C500100001	WDR100029962	1.8
271781	5S	Central Valley (Sacramento)	City of Lathrop Consolidated Treatment Facility	Lathrop City	18800 Christopher Way	Lathrop	95330	San Joaquin	395597	5B391076001	WDR100030293	1.55
257927	5S	Central Valley (Sacramento)	Southeast Regional WW System	Lake Cnty	2485 Old Hwy 53	Clearlake	95422	Lake	146234	5A170102002	WDR100030715	6.1
238365	5S	Central Valley (Sacramento)	Lincoln City WWTF	Lincoln City	1245 Fiddlyment Road	Lincoln	95648	Placer	428207	5A31NP00011	WDR100030795	8.4
272444	5S	Central Valley (Sacramento)	White Slough Water Pollution Control Facility	Lodi City	12751 North Thornton Road	Lodi	95242	San Joaquin	333528, 428201	5B390103002	WDR100030994	8.5
230812	5S	Central Valley (Sacramento)	Hughson WWTF	Hughson City	6700 Leedom Road	Hughson	95326	Stanislaus	383599	5C500101002	WDR100031107	1.8
226690	5S	Central Valley (Sacramento)	Galt WWTP & Reclamation Facility	Galt City	10059 Twin Cities Road	Galt	95632	Sacramento	404159	5B340101001	WDR100031184	3
232656	5S	Central Valley (Sacramento)	Ironhouse WWTF	Ironhouse Sanitary District	450 Walnut Meadows Drive	Oakley	94561	Contra Costa	428157	5B07NP00013	WDR100031539	4.3
245602	5S	Central Valley (Sacramento)	Oakdale WWTF	Oakdale City	9700 Liberrini	Oakdale	95361	Stanislaus	385669	5C500104001	WDR100032130	2.45
247782	5S	Central Valley (Sacramento)	City of Patterson WQCF	Patterson City	14901 Poplar Avenue	Patterson	95363	Stanislaus	425768	5B50NC00002	WDR100032803	2.25
244250	5S	Central Valley (Sacramento)	City of Newman Wastewater Treatment Facility	Newman City	2600 Hill Ferry Road	Newman	95360	Stanislaus	420963	5C500103001	WDR100033379	1.69
239729	5S	Central Valley (Sacramento)	Marysville WWTP	Marysville City	526 C Street	Marysville	95901	Yuba	148426	5A680101001	WDR100033389	1.7
266223	5S	Central Valley (Sacramento)	Tracy WWTP	Tracy City	3900 Holly Drive	Tracy	95304	San Joaquin	416413	5B390108001	WDR100033942	10.8
252782	5S	Central Valley (Sacramento)	Ripon Industrial & Domestic TP	Ripon City	259 N. Wilma Ave	Ripon	95366	San Joaquin	140988	5B390105001	WDR100035427	2.34
255081	5S	Central Valley (Sacramento)	Salida WWTP	Salida Sanitary District	6200 Pirrone Road	Salida	95368	Stanislaus	142003	5C500107001	WDR100035503	2.29
252871	5S	Central Valley (Sacramento)	Riverbank WWTP	Riverbank City	23865 South Santa Fe Road	Riverbank	95367	San Joaquin	141726	5C500106002	WDR100035552	7.5

**ATTACHMENT 2 - LIST OF FACILITIES**  
**WATER CODE SECTION 13267/13383 ORDER FOR THE**  
**DETERMINATION OF THE PRESENCE OF PER-AND POLYFLUOROALKYL SUBSTANCES AT PUBLICLY OWNED TREATMENT WORKS (POTWS)**

Facility ID	Region #	Regional Board	Facility Name	Agency Name	Address	City	Zip	County	Reg Measure ID	WDID	GeoTracker Global ID	Design Flow MGD
220768	5S	Central Valley (Sacramento)	Dry Creek WWTP	Roseville City	1800 Booth Road	Roseville	95747	Placer	426201	5A310106001	WDR100035995	18
271836	5S	Central Valley (Sacramento)	Waterford WWTP	Waterford City	335 South Western Avenue	Waterford	95386	Stanislaus	140995	5C500113001	WDR100036083	1
272960	5S	Central Valley (Sacramento)	Woodland Water Pollution Control Facility	Woodland City	42929 County Road 24	Woodland	95776	Yolo	398643	5A570105001	WDR100039486	10.4
239343	5S	Central Valley (Sacramento)	City of Manteca WW Quality Control Facility	Manteca City	2450 West Yosemite Avenue	Manteca	95337	San Joaquin	400860, 432653	5B390104001	WDR100045342	9.87
241598	5S	Central Valley (Sacramento)	Mountain House WWTP	Mountain House CSD	17103 West Bethany Road	Mountain House	95391	San Joaquin	416414	5B391078003	WDR100046414	3
204475	6	Lahontan	Adelanto WWTP	Adelanto Public Utility Authority	19101 Jonathan Street P.O. Box 771	Adelanto	92301	San Bernardino	392758	6B369805001	WDR100026851	4
209662	6	Lahontan	Bishop Sewage Treatment Plant	Bishop City	377 W. Line Street	Bishop	93514	Inyo	148110	6B140101001	WDR100027094	1.6
259230	6	Lahontan	STPUD Wastewater Treatment Plant	South Tahoe PUD	1275 Meadow Crest Drive	South Lake Tahoe	96150	El Dorado	132539, 375578	6A021008003	WDR100034185	7.7
262840	6	Lahontan	Mantis Valley Water Reclamation Plant	Tahoe-Truckee Sanitation Agency	13720 Butterfield Drive	Truckee	96161	Nevada	131270	6A290011000	WDR100034937	9.6
761913	6	Lahontan	VVWRA Sub-Regional Plant-Apple Valley	Victor Valley Wastewater Reclamation Authority	21012 Otoe Road	Apple Valley	92307	San Bernardino	377321	6B360907006	WDR100036875	1
761903	6	Lahontan	VVWRA- Sub-Regional Plant-Hesperia	Victor Valley Wastewater Reclamation Authority	14269 Mojave St	Hesperia	92345	San Bernardino	377320	6B360907005	WDR100036876	1
270419	6	Lahontan	Victor Valley Wastewater Reclamation Authority WTP	Victor Valley Wastewater Reclamation Authority	20111 Shay Road	Victorville	92394	San Bernardino	400390	6B360109001	WDR100036878	18
747480	6	Lahontan	SCLA Central WWTP-Victorville Water Dist	Victorville City	14343 Civic Center Drive	Victorville	92392	San Bernardino	394630	6B360911001	WDR100036880	2.5
236378	6	Lahontan	Lancaster Water Reclamation Plant	Los Angeles County Sanitation District 14	1865 West Avenue D	Lancaster	93534	Los Angeles	132044	6B190107017	WDR100030189	18
247448	6	Lahontan	Palmdale Water Reclamation Plant	Los Angeles County Sanitation District 20	39300 30th Street E and Avenue P	Palmdale	93550	Los Angeles	382094	6B190107069	WDR100030237	15
239283	6	Lahontan	Mammoth CWD STP	Mammoth Water District	1315 Meridian Blvd	Mammoth Lakes	93546	Mono	145892, 434236	6B260103001	WDR100033952	2.2
208769	6	Lahontan	Barstow WTF Mojave River Bed	Barstow City	2200 E Riverside Drive	Barstow	92311	San Bernardino	427492	6B360101001	WDR100027318	4.5
252695	6	Lahontan	Ridgecrest	Ridgecrest City	Pole Line Road and N. Knox Road	China Lake	93555	Kern	140415	6B150116001	WDR100035359	3.6



**ATTACHMENT 2 - LIST OF FACILITIES**  
**WATER CODE SECTION 13267/13383 ORDER FOR THE**  
**DETERMINATION OF THE PRESENCE OF PER-AND POLYFLUOROALKYL SUBSTANCES AT PUBLICLY OWNED TREATMENT WORKS (POTWS)**

Facility ID	Region #	Regional Board	Facility Name	Agency Name	Address	City	Zip	County	Reg Measure ID	WDID	GeoTracker Global ID	Design Flow MGD
236181	6	Lahontan	Lake Arrowhead CSD WTFS	Lake Arrowhead Community Services District	P.O. Box 700	Lake Arrowhead	92352	San Bernardino	367835	6B360107001	WDR100030590	4
253293	6	Lahontan	Rosamond WTF (Ponds)	Rosamond CSD	875 Patterson Road	Rosamond	93560	Kern	425543	6B150112001	WDR100035936	1.27
230011	6	Lahontan	Helendale Silvertakes STP	Helendale CSD	Wild Road and Helendale Road	Helendale	92342	San Bernardino	403017	6B361111001	WDR100031398	1.2
212648	6	Lahontan	California City WTF	City of California City	10835 Nelson Dr.	California City	93595	Kern	148046	6B150118001	WDR100029631	1.5
234123	6	Lahontan	June Lake PUD STP	June Lake PUD	45125 Highway 395	June Lake	93529	Mono	146152	6B260101002	WDR100030395	1
259689	6	Lahontan	Susanville CSD	Susanville Consol SD	476-200 Paul Bunyan Road	Susanville	96130	Lassen	350221	6A181554001	NPDP100051561	2
214933	7	Colorado River	Coachella SD WWTP	Coachella SD	87075 Avenue 54	Coachella	92236	Riverside	400532	7A330104012	WDR100029782	2.4
232297	7	Colorado River	Imperial City WWTP	Imperial City	701 East 14th Street	Imperial	92251	Imperial	402991	7A130106011	NPDP100051493	1.4
210272	7	Colorado River	Brawley City WWTP	Brawley City	5015 Best Road	Brawley	92227	Imperial	399799	7A130100011	NPDP100051507	6
270096	7	Colorado River	Valley SD WWTP	Valley Sanitary District	45500 Van Buren Street	Indio	92201	Riverside	401332	7A330122021	NPDP100051522	8.5
222407	7	Colorado River	El Centro City WWTP	El Centro City	2255 La Brucherie Road	El Centro	92243	Imperial	396224, 429474	7A130103011	NPDP100051524	8
216446	7	Colorado River	Coachella Valley WD WWTP	Coachella Valley WD	63-002 Filmore Street	Thermal	92274	Riverside	413411	7A330105091	NPDP100051575	7
212739	7	Colorado River	Calipatria City WWTP	Calipatria City	106 Lindsey Road	Calipatria	92233	Imperial	402048	7A130102041	NPDP100051642	1.7
208668	7	Colorado River	City of Banning WWTP	Banning City	2242 East Charles Street	Banning	92220	Riverside	407229	7A330100015	WDR100027202	3.6
209847	7	Colorado River	Blythe Regional WW Reclamation Facilities	Blythe City	15901 South Broadway	Blythe	92225	Riverside	407226	7B330102012	WDR100027223	2.4
208930	7	Colorado River	BB Reg WWA-Lucerne Vly	Big Bear Area Regional WW Agency	122 Palomino Drive	Big Bear City	92314	San Bernardino	407233	7A360100011	WDR100027897	3.2
247435	7	Colorado River	Palm Springs WWTF	Palm Springs City	4375 Mesquite Avenue	Palm Springs	92264	Riverside	391803	7A330114012	WDR100032535	16.5
204870	7	Colorado River	Alan Horton WWTP	Mission Springs Water District	14601 Verbena	Desert Hot Springs	92240	Riverside	395089	7A330109012	WDR100033271	1
247419	7	Colorado River	Palm Desert WRP #10	Coachella Valley WD	43-000 Cook Street	Palm Springs	92211	Riverside	420073	7A330105012	WDR100029854	18
216445	7	Colorado River	CVWD Improv Dist #58	Coachella Valley WD	85-995 Avenue 52 P.O. Box 1058	Coachella	92236	Riverside	382776	7A330105071	WDR100029790	5
212589	7	Colorado River Basin	City of Calexico WWTP	Calexico City	298 East Road	Calexico	92231	Imperial	427929	7A130101011	NPDP100051615	4.3

**ATTACHMENT 2 - LIST OF FACILITIES**  
**WATER CODE SECTION 13267/13383 ORDER FOR THE**  
**DETERMINATION OF THE PRESENCE OF PER-AND POLYFLUOROALKYL SUBSTANCES AT PUBLICLY OWNED TREATMENT WORKS (POTWS)**

Facility ID	Region #	Regional Board	Facility Name	Agency Name	Address	City	Zip	County	Reg Measure ID	WDID	GeoTracker Global ID	Design Flow MGD
244080	7	Colorado River Basin	Needles WWTP	Needles City	516 Broadway	Needles	92363	San Bernardino	400298	7B360110014	WDR100053504	1.2
259156	8	Santa Ana	Michelson WWRF	Irvine Ranch Water District	3512 Michelson Drive	Irvine	92612	Orange	402182	8 302006002	NPD100051948	33.5
259209	8	Santa Ana	Perris Valley RWRF	Eastern Municipal Water District	1301 Case Road	Perris	92570	Riverside	354386	8 332783001	WDR100028677	30
259193	8	Santa Ana	San Jacinto Valley RWRF	Eastern Municipal Water District	770 North Sanderson	San Jacinto	92582	Riverside	354386	8 332783001	WDR100028733	14.9
758392	8	Santa Ana	OCSD Plant 1	Orange CSD	10844 Ellis Ave	Fountain Valley	92708	Orange	386791	8 300110002	NPD100052063	332
259158	8	Santa Ana	OCSD Plant 2	Orange CSD	22212 Brookhurst St	Huntington Beach	92646	Orange	386791	8 300110002	NPD100051862	332
259150	8	Santa Ana	Riverside City WWRF	Riverside City	5950 Acom Street	Riverside	92504	Riverside	376054	8 330117003	NPD100051476	46
259178	8	Santa Ana	Colton/San Bernardino STP, RIX	Colton/San Bernardino RTT&WRA	1990 Agua Mansa Road	Colton	92324	San Bernardino	392858	8 362375001	NPD100051496	40
259220	8	Santa Ana	Margaret H Chandler WWRF	San Bernardino City Municipal Water Dept	399 Chandler Place	San Bernardino	92408	San Bernardino	418662	8 360114003	NPD100051499	4.5
259171	8	Santa Ana	Corona WWRF #1	Corona City DWP	2205 Railroad Street	Corona	92880	Riverside	388613	8 330108001	NPD100051505	11.5
259205	8	Santa Ana	WRCRWA Regional WWRF	Western Riverside County Regional Wastewater Authority	14634 River Rd	Corona	92880	Riverside	396787	8 332353001	NPD100051521	14
259184	8	Santa Ana	IEUA Carbon Canyon WWRF	Inland Empire Utilities Agency	14950 Telephone Avenue	Chino	91708	San Bernardino	394393	8 362918001	NPD100051553	85
259161	8	Santa Ana	Henry N. Wochholz WWRF	Yucaipa Valley Water District	880 W County Line Ln	Calimesa	92320	San Bernardino	380760	8 362222001	NPD100051607	8
259214	8	Santa Ana	EVMWD Regional WWRF	Elsinore Valley Municipal Water Dist	14980 Strickland Road	Lake Elsinore	92531	Riverside	371955	8 330112001	NPD100051619	8
259216	8	Santa Ana	Temescal Valley WD WWRF	Temescal Valley Water District	22646 Temescal Canyon Road	Corona	92883	Riverside	388621	8 332253001	NPD100051628	1.58
259149	8	Santa Ana	Rialto WWRF	Rialto City	501 East Santa Ana Avenue	Bloomington	92316	San Bernardino	381374	8 360112001	NPD100051632	11.7
259170	8	Santa Ana	Beaumont WWTP No. 1	Beaumont City	715 West 4th Street	Beaumont	92301	Riverside	387658	8 330101001	NPD100051636	4
259181	8	Santa Ana	Big Bear WWRF	Big Bear Area Regional WW Agency	122 Palomino Drive	Big Bear	92314	San Bernardino	297017	8 360108001	WDR100027900	3.2
271777	8	Santa Ana	El Toro Water Dist WWRF	El Toro Water District	23542 Moulton Parkway	Laguna Hills	92653	Orange	402417	8 303652001	WDR100028257	6
259210	8	Santa Ana	EVMWD Railroad Canyon WWRF	Elsinore Valley Municipal Water Dist	29182 Railroad Canyon Road	Lake Elsinore	92532	Riverside	140802	8 332122003	WDR100028327	1.3

**ATTACHMENT 2 - LIST OF FACILITIES**  
**WATER CODE SECTION 13267/13383 ORDER FOR THE**  
**DETERMINATION OF THE PRESENCE OF PER-AND POLYFLUOROALKYL SUBSTANCES AT PUBLICLY OWNED TREATMENT WORKS (POTWS)**

Facility ID	Region #	Regional Board	Facility Name	Agency Name	Address	City	Zip	County	Reg Measure ID	WDID	GeoTracker Global ID	Design Flow MGD
259203	8	Santa Ana	Moreno Valley RWRP	Eastern Municipal Water District	17140 Kitching Street	Moreno Valley	92551	Riverside	354386	8 332783001	WDR100028673	20.8
259173	8	Santa Ana	Corona WWRF #2	Corona City DWP	650 Harrison Street	Corona	92879	Riverside	374041	8 332181001	WDR100028679	3
643085	8	Santa Ana	Lytle Creek North WWTP	San Bernardino Cnty Special Districts	18100 Institution Road	San Bernardino	92321	San Bernardino	334494	8 362899001	WDR100035823	1.75
259148	8	Santa Ana	Redlands WWRF	Redlands City	1950 Nevada Street	Redlands	92373	San Bernardino	144066	8 360111001	WDR100035978	12
259160	8	Santa Ana	Running Springs WWTP	Running Springs Water Dist	3400 Sewer Plant Road	Running Springs	92382	San Bernardino	138550	8 360113001	WDR100036054	1
259174	8	Santa Ana	Corona WWRF #3	Corona City DWP	3997 Temescal Canyon Road	Corona	92883	Riverside	395382	8 332476001	WDR100051484	1
259165	8	Santa Ana	IEUA Regional Plant No. 1	Inland Empire Utilities Agency	2450 Philadelphia Street	Ontario	91761	San Bernardino	394393	8 362918001	WDR100052088	44
742794	8	Santa Ana	IEUA Regional Plant No. 4	Inland Empire Utilities Agency	12811 Sixth Street	Rancho Cucamonga	91729	San Bernardino	394393	8 362918001	WDR100052335	14
259169	8	Santa Ana	IEUA Regional Plant No. 5	Inland Empire Utilities Agency	6068 Kimball Avenue	Chino	91710	San Bernardino	394393	8 362918001	WDR100052089	15
257520	9	San Diego	SMWD Oso Creek WRP	SOCWA-Recycled Water Use	27204 La Paz Rd	Mission Viejo	92692	Orange	142903	9 000000541	WDR100035188	6
262995	9	San Diego	TCWD Goren WTP	SOCWA-Recycled Water Use	Live Oak Canyon Road	Trabuco Canyon	92679	Orange	142903	9 000000541	WDR100051995	6
262996	9	San Diego	TCWD Robinson Ranch WRF	SOCWA-Recycled Water Use	21397 Heritage Rd	Trabuco Canyon	92679	Orange	142903	9 000000541	WDR100035245	6
229726	9	San Diego	HARRF DISCH to San Elijo Ocean Outfall	Escondido City	1521 Hale Avenue	Escondido	92029	San Diego	420777	9 000000031	WDR100028566	18
236619	9	San Diego	La Salina WWTP, Oceanside Ocean Outfall	Oceanside City	1330 South Tait Street	Oceanside	92054	San Diego	377272	9 000000146	WDR100052059	22.6
255392	9	San Diego	San Luis Rey Water Reclamation Facility	Oceanside City	3950 North River Road	Oceanside	92058	San Diego	377272	9 000000146	WDR100032206	22.6
237396	9	San Diego	IRWD Los Alisos WRP	SOCWA-Aliso Creek Ocean O/F	15600 Sand Canyon Avenue	Irvine	92618	Orange	384629	9 000000117	WDR100051948	34.37
241053	9	San Diego	SOCWA Regional TP	SOCWA-Aliso Creek Ocean O/F	29201 La Paz Rd	Laguna Niguel	92677	Orange	384629	9 000000117	WDR100035244	34.37
236649	9	San Diego	Latham WWP	SOCWA-San Juan Creek Ocean O/F	34152 Del Obispo	Dana Point	92629	Orange	384618	9 000000175	WDR100051861	38.78
257518	9	San Diego	SMWD-Chiquita WRP	SOCWA-San Juan Creek Ocean O/F	28793 Ortega Highway	San Juan Capistrano	92675	Orange	384618	9 000000175	WDR100035190	38.78
269989	9	San Diego	Vallecitos WD Meadowlark WRP	Encina Wastewater Authority	7941 Corintia Street	Carlsbad	92009	San Diego	425154	9 000000030	WDR100052061	48
263145	9	San Diego	Temecula Valley RWRP	Eastern Municipal Water District	42565 Avenida Alvarado	Temecula	92590	Riverside	354386	8 332783001	WDR100028741	22.4

**ATTACHMENT 2 - LIST OF FACILITIES**  
**WATER CODE SECTION 13267/13383 ORDER FOR THE**  
**DETERMINATION OF THE PRESENCE OF PER-AND POLYFLUOROALKYL SUBSTANCES AT PUBLICLY OWNED TREATMENT WORKS (POTWS)**

Facility ID	Region #	Regional Board	Facility Name	Agency Name	Address	City	Zip	County	Reg Measure ID	WDID	GeoTracker Global ID	Design Flow MGD
257821	9	San Diego	South Bay International WTP	IBWC-US & Mexico Section	2995 Clearwater Way	San Diego	92154	San Diego	397052	9 000000732	NPD100051492	25
248796	9	San Diego	Point Loma WWTP & Ocean Outfall	San Diego City Metropolitan Wastewater Dept (Public Utilities)	1902 Gatchell Road	San Diego	92106	San Diego	414988	9 000000275	NPD100051514	240
224137	9	San Diego	Fallbrook Water Reclamation Plant	Fallbrook Public Utility District	1425 South Alturas Street	Fallbrook	92028	San Diego	401760	9 000000115	WDR100028880	2.7
222758	9	San Diego	Encina WRCPF	Encina Wastewater Authority	6200 Avenida Encinas	Carlsbad	92009	San Diego	425154	9 000000030	NPD100052058	7
213270	9	San Diego	Carlsbad WRF	Carlsbad MWD	6200 Avenida Encinas	Carlsbad	92009	San Diego	408361, 425154	9 000000929	WDR100029522	48
202611	9	San Diego	4-S Ranch WRF	Olivenhain Municipal Water District	16595 Dove Canyon Road	San Diego	92127	San Diego	401754	9 000000371	WDR100032324	1.6
247351	9	San Diego	Ray Stoyer Water Recycling Facility	Padre Dam Municipal Water District	12001 North Fanita Parkway	Santee	92071	San Diego	142902	9 000000542	WDR100032406	2
251548	9	San Diego	Ralph W Chapman WRF	Otay MWD	11901 Singer Lane	Spring Valley	91978	San Diego	401763	9 000000217	WDR100032712	1.3
255265	9	San Diego	San Elijo Water Reclamation Facility	San Elijo Joint Powers	2695 Manchester Avenue	Encinitas	92007	San Diego	147513	9 000000125	WDR100035075	5.25
241054	9	San Diego	3A Treatment Plant	SOCWA-Recycled Water Use	26801 Camino Capistrano	Laguna Niguel	92677	Orange	142903	9 000000541	WDR100035186	6
257850	9	San Diego	SOCWA Coastal TP	SOCWA-Recycled Water Use	28303 Alicia Pkwy	Laguna Niguel	92677	Orange	402976	9 000000541	WDR100035192	6
255218	9	San Diego	City of San Clemente WRP	SOCWA-San Juan Creek Ocean O/F	380 Avenida Pico	San Clemente	92672	Orange	402929	9 000000175	WDR100035884	38.78
244506	9	San Diego	North City WRP	San Diego City Metropolitan Wastewater Dept (Public Utilities)	4949 Eastgate Mall	San Diego	92121	San Diego	402158	9 000000730	WDR100035946	60
257831	9	San Diego	South Bay WRP	San Diego City Metropolitan Wastewater Dept (Public Utilities)	2411 Dairy Mart Road	San Diego	92154	San Diego	148190	9 000000900	WDR100035948	15
255679	9	San Diego	Santa Maria WWTP	Ramona MWD	260 Sawday Street	Ramona	92065	San Diego	404699	9 000000077	WDR100037620	1.35

**ATTACHMENT 3**  
**TECHNICAL SAMPLING AND REPORTING REQUIREMENTS**

**WATER CODE SECTION 13267/13383 ORDER FOR THE  
DETERMINATION OF THE PRESENCE OF PER-AND POLYFLUOROALKYL SUBSTANCES AT  
PUBLICLY OWNED TREATMENT WORKS (POTWs)**

**Content:**

- A. Justification*
- B. Sampling and Analysis Requirements*
- C. Reporting Requirements*

California Water Code Section 13267b (1) requires a written explanation of the need for reports and the evidence that supports requiring the reports. This justification is provided in Section A. The technical requirements for this Order include Sampling and Analysis (Section B) and Reporting (Section C). Section B describes the general sampling and analysis requirements with specifics about the types and frequency of sample collection for the POTW and groundwater monitoring wells. Groundwater monitoring well sampling is only required for those POTWs with an existing groundwater monitoring program approved by the Regional Board. Section C describes the reports required for the submittal of completed sampling and analysis conducted pursuant to Section B, below. Section D requires a questionnaire to be completed for each POTW by the responsible agency. The completed questionnaire provides various information about the processes of the POTW, including wastewater and biosolids – commonly associated with the presence of PFAS at POTWs, based on recent studies across the US and the world.

**A. JUSTIFICATION**

Studies being conducted across the nation are linking consumer and industrial use of PFAS-containing materials, including disposal of landfill leachate and firefighting foam, to PFAS results in the influent and effluent discharge at POTWs. Two examples are provided below based on a January 2020 POTW study in Vermont and a 2014 study performed in the San Francisco (SF) Bay Area in California.

The State of Vermont's recently published January 2020 results<sup>1</sup> indicate widespread presence of PFAS at their POTWs. Sampling and analysis were performed from 1) landfill leachate at four landfills and 2) POTW influent, effluent, and sludge, and septage at 30 POTWs. Some of the key take-aways from this report are:

---

<sup>1</sup> 2020. Poly- and Perfluoroalkyl Substances at Wastewater Treatment Facilities and Landfill Leachate – [2019 Summary Report](https://dec.vermont.gov/sites/dec/files/wmp/SolidWaste/Documents/02.03.20_PFASto%20in%20LF%20and%20WWTF%20Final%20Report.pdf). Weston & Sampson. January 30.  
([https://dec.vermont.gov/sites/dec/files/wmp/SolidWaste/Documents/02.03.20\\_PFASto%20in%20LF%20and%20WWTF%20Final%20Report.pdf](https://dec.vermont.gov/sites/dec/files/wmp/SolidWaste/Documents/02.03.20_PFASto%20in%20LF%20and%20WWTF%20Final%20Report.pdf))

- PFAS are present in all landfill leachate (correlates to data being reported from statewide PFAS Orders sent to California landfills in March 2019)
- PFAS are also present in all POTW influent, effluent, and sludge tested.
- Reductions in PFAS concentrations between influent and effluent samples implies sorption to sludges may be occurring.
- Concentrations of PFAS “replacement” compounds exceed the concentrations of the original compounds of PFOA and PFOS.
- Correlations between leachate and sludges (includes biosolids) were challenged by analytical method limitations and collection of uniform percent solid samples.

In California, wastewater effluent samples were collected from eight POTWs in 2009 and 2014 that discharge into the SF Bay<sup>2</sup>. All samples contained PFAS among the 20 compounds analyzed. The study summarized that PFAS concentrations were about the same in the effluent since the 2009 sampling efforts except for two POTWs where the effluent concentrations were significantly higher since 2009 suggesting recent contributions from PFAS in the POTW's influent.

## **B. SAMPLING AND ANALYSIS REQUIREMENTS**

### **1. General Sampling and Analysis Requirements**

- a. Samples and measurements taken as required herein shall be representative of the volume and nature of the monitored discharge per their existing monitoring and reporting program. All samples shall be taken at the monitoring locations specified below and, unless otherwise specified, before the monitored flow joins or is diluted by any other waste stream, body of water, or substance.
- b. Samples of the influent and effluent from the treatment system shall be a 24-hour composite for each sample. When using a composite sampler, information on the type of tubing used must be provided. Fluoropolymer tubing, parts, valves, and other parts should be avoided. Preferable materials include high-density, polyethylene (HDPE), polypropylene, silicone, stainless steel, nylon, PVC, and acetate. Equipment that contains fluoropolymer parts can be used if those parts are internal to the equipment and does not contact the sample. If a composite sampler is used that has fluoropolymer parts, then an equipment blank sample must be collected for each composite sampler used and analyzed for PFAS to determine the potential contribution by the sampler of fluoropolymers in the sample.
- c. For POTWs that also sample effluent after advanced treatment to meet a Surface Water Source Augmentation Project (SWSAP) (California Code of Regulations Title 22 Sections 60320.300 through 60320.330), the sample location specified in

---

<sup>2</sup> 2016. Poly- and perfluoroalkyl substances in wastewater: Significance of unknown precursors, manufacturing shifts, and likely AFFF impacts. Erika F. Houtz, Rebecca Sutton, June-Soo Park, Margaret Sedlak. Water Research, Volume 95, 15 May 2016, Pages 142-149.

this Order can be the same location of the representative sample collected of the recycled municipal wastewater in the SWSAP.

- d. Influent samples shall be taken from locations prior to primary settling, which include but are not limited to the headworks of the inlet to the grit chamber or prior to any biological treatment. Samples shall be collected at such a point and in such a manner to ensure a representative sample of influent containing all wastes accepted by the facility prior to any treatment.
- e. Effluent samples shall be taken following completion of all treatment processes and prior to mixing with the receiving waters. (i.e., surface water, groundwater, or ocean). Samples shall be collected at such a point and in such a manner to ensure a representative sample of the discharge. For POTWs that also sample effluent per Title 22 requirements, the effluent sample mentioned in this Order may be taken at the same location.

If, following completion of treatment, the effluent is placed into storage pond(s) and not discharged into receiving waters, , then the effluent sample shall be collected from the treatment system discharge following completion of treatment and prior to the entering the effluent storage pond(s).

- f. Sample of the reverse osmosis concentrate/retentate shall be collected via grab sample method and must be representative of the volume and nature of the discharge.
- g. Appropriate flow measurement devices and methods consistent with accepted scientific practices shall be selected and used to ensure the accuracy and reliability of measurements of the volume of monitored discharges. All monitoring instruments and devices used by the responsible agency to fulfill the prescribed monitoring program shall be properly maintained and calibrated as necessary, at least yearly, to ensure their continued accuracy. All flow measurement devices shall be calibrated at least once per year to ensure continued accuracy of the devices.
- h. Sampling for biosolids after all treatment processes have been completed shall be made either prior to or post biosolids harvesting for dewatering and disposal/reuse. Samples may be collected from biosolids storage ponds, biosolids drying beds, post-processing storage piles or other similar points after processing and prior to disposal/reuse. When reporting the data, the concentrations of PFAS in the sample as provided to the laboratory and the percent moisture shall be reported. Also include the class of biosolids sampled in the report. A representative whole sample aliquot (both fractions) will be collected, analyzed by the laboratory, and reported in nanograms per kilogram.
- i. Sample results from liquid samples shall be reported in units of nanograms per liter (ng/L). Sample results for biosolids shall be reported in units of nanograms per kilogram (ng/kg).

- j. Monitoring results shall be reported at intervals and in a manner specified below in Section C.2 and C.3.
- k. A laboratory providing sample analyses must hold a valid certificate of accreditation from the State of California Environmental Laboratory Accreditation Program (ELAP) for the analytes selected in Table 1 in compliance with Department of Defense (DoD) Table B-15 of Quality Systems Manual (QSM), dated 2017, version 5.1 or later. The laboratory must be capable of achieving the quality control/quality assurance requirements specified in Table B-15 of the DoD QSM, version 5.1 or later. The DoD QSM can be found at: <https://denix.osd.mil/edqw/documents/> as well as on the State Water Board's PFAS informational website: <https://www.waterboards.ca.gov/pfas/background.html/>.

A list of laboratories that are accredited by ELAP can be found on the State Water Board's PFAS webpage: <https://www.waterboards.ca.gov/pfas/>.

Analytical reporting limits for sample matrices can be found on the Water Board's PFAS webpage: <https://www.waterboards.ca.gov/pfas/> (under non-drinking water tab, then Documents folder).

- l. PFAS sample collection protocol shall follow the guidance located at: [https://www.waterboards.ca.gov/pfas/docs/march\\_pfas\\_sampling\\_guidelines.pdf](https://www.waterboards.ca.gov/pfas/docs/march_pfas_sampling_guidelines.pdf).
- m. Collection of biosolid samples shall follow U.S. EPA's Sampling Procedures and Protocols for the National Sewage Sludge Survey located at: [https://www.epa.gov/sites/production/files/2015-04/documents/nsss1988\\_sampling\\_procedures.pdf](https://www.epa.gov/sites/production/files/2015-04/documents/nsss1988_sampling_procedures.pdf)

## 2. Treatment System Sampling Locations and Frequencies

- a. For POTWs with average dry weather design flows of five mgd or greater:
  - i. Sampling shall commence with the Fourth Quarter 2020 sampling period (October-December 2020).
  - ii. Sampling and analysis for PFAS of the POTW influent, effluent, and reverse osmosis concentrate/retentate shall occur quarterly for a one-year period.
  - iii. Biosolids shall be sampled to determine its PFAS and moisture content quarterly for a one-year period.
- b. For POTWs with average dry weather design flows less than five mgd, but greater than or equal to one mgd:
  - i. Sampling shall commence with the Fourth Quarter 2020 sampling period (October-December 2020).



- ii. Sampling and analysis for PFAS of the POTW influent, effluent, and reverse osmosis concentrate/retentate shall occur quarterly for a one-year period.
- iii. Biosolids shall be sampled to determine its PFAS and moisture content once during the first year of this Order.

### **3. Groundwater Monitoring Well Sampling and Analysis**

- a. One-time groundwater monitoring for PFAS is required for POTWs with existing groundwater monitoring and reporting programs under an order (e.g., monitoring and reporting program) issued by the State or Regional Board.
- b. Within **60-days prior to conducting the first groundwater monitoring event**, the responsible agency shall provide to the appropriate Regional Water Board the following information:
  - i. A figure of the groundwater monitoring well network, groundwater flow direction, and indicate of the monitoring wells proposed to be sampled.
  - ii. Rationale for the selection of the groundwater monitoring wells to be used for representative sampling for PFAS. A minimum of three wells in the upper water bearing zone shall be selected.
  - i. After the Regional Board approves the PFAS groundwater monitoring proposal, monitoring shall commence during the next groundwater monitoring period as specified in the POTWs existing groundwater monitoring and reporting program but **no sooner than the Fourth Quarter 2020 sampling period (October-December 2020)**.
  - ii. The PFAS analytes mentioned in Section B.1.j will be analyzed from the samples collected from selected groundwater monitoring wells once within the first year of implementation of this order.
- c. The collection of samples shall comply with the standard operating procedures for sample collection established for the existing groundwater monitoring program (including the field parameters and general chemistry parameters in Table 2 of this Attachment) and supplemented by the PFAS-specific adjustments required under Section B.1.I.

## **C. REPORTING REQUIREMENTS**

### **1. General Reporting Requirements**

- a. All documentation, including but not limited to, the groundwater monitoring proposal, reports (treatment sampling and analysis and/or groundwater analysis)

and analytical reports must be uploaded into GeoTracker via the Electronic Submittal of Information (ESI) Portal, as stipulated by California State law (California Code of Regulations Title 23, Division 3, Chapter 30). The groundwater monitoring proposal and final report must be submitted in a searchable portable document format (pdf) with transmittal letter, text, tables, figures, laboratory analytical data, and appendices (one PDF for the entire report) as well as analytical data in electronic data deliverable (EDD) format.

Instructions on how to log into GeoTracker and upload reports and documents into the ESI portal is available at:

[https://www.waterboards.ca.gov/ust/electronic\\_submittal/index.html](https://www.waterboards.ca.gov/ust/electronic_submittal/index.html). Step by step instructions are provided in the ESI Guide for Responsible Parties under the "Getting Started" section of this webpage.

GeoTracker Help Desk assistance can be found on the ESI homepage ([www.waterboards.ca.gov/water\\_issues/programs/ust/electronic\\_submittal](http://www.waterboards.ca.gov/water_issues/programs/ust/electronic_submittal)).

Note: The EDD requirement includes all analytical data, sampling location information, monitoring well information (e.g. latitudes, longitudes, elevations, and depth to water, well construction information, site maps, and boring logs).

- b. The report must provide a description of the sampling activities, summary of the analytical results, copy of the chain of custody, and a copy of the laboratory analytical results.
- c. In the monitoring report, the responsible agency must certify that the sampling for PFAS was conducted according to the guidance documents in Section B.1.l and B.1.m. If deviations from the guidance occurred, details on those deviations need to be included in the report.
- d. The responsible agency must acknowledge compliance with the guidance documents listed in Section B.1.l and B.1.m, and if not, provide rationale for any variations in the report.

## **2. Monitoring Report for the Treatment System Sampling and Groundwater Sampling Analysis Results**

- a. Analytical results from the treatment system sampling and groundwater sampling event will be uploaded within **30 days** of receiving laboratory analytical report into GeoTracker's ESI portal.
- b. One monitoring report for the treatment system and groundwater monitoring shall be submitted into GeoTracker's ESI portal no later than **60 days** following the receipt of the last analytical laboratory report.

- c. The monitoring report shall include text describing the sampling locations utilized and a figure of the facility with locations of the influent and effluent samples (include locations of representative sampling points (e.g. sampling points for more than one influent or effluent line)), groundwater monitoring wells, biosolids samples, brine line samples (if applicable), and flow measurement devices (mentioned in Section B.1.d).
- d. The report shall include all reported data (analytical results, flow measurements, groundwater monitoring well measurements (if applicable) in a tabular format.
- e. The report shall include all laboratory analysis sheets, including quality assurance/quality control information for which sample analyses were performed.
- f. The report shall include a description of any variations in sampling from what was provided to the Regional Water Board as part of Section C.3.b.

### 3. POTW Informational Questionnaire

- a. A link to an Adobe Acrobat-fillable questionnaire will be sent via email to the responsible agency when the Order is issued. The format of the questionnaire and instructions on how to complete the questionnaire is provided in **Section D**.
- b. The questionnaire shall be completed by the responsible agency and submitted **no later than the submittal of the second quarter analytical results** from the treatment system sampling.
- c. The responsible agency shall upload the completed questionnaire and attachments requested in the questionnaire as separate ESI files in GeoTracker using the responsible party's GeoTracker Global ID number (Attachment 2).
- d. Instructions on how to log into GeoTracker is available at: [https://www.waterboards.ca.gov/ust/electronic\\_submittal/index.html](https://www.waterboards.ca.gov/ust/electronic_submittal/index.html). Step by step instructions are provided in the *ESI Guide for Responsible Parties* under the "Getting Started" section of this webpage.

GeoTracker Help Desk assistance can be found on the ESI homepage at: [www.waterboards.ca.gov/water\\_issues/programs/ust/electronic\\_submittal](http://www.waterboards.ca.gov/water_issues/programs/ust/electronic_submittal).

- e. The minimum information identified below is included in the questionnaire. The questionnaire spreadsheet will be pre-populated with information since the responsible agency has already submitted the same information to the State Water Board (those items are shown in bracket [] form).
  - i. Waste Discharger Identification (WDID) Number [WDID].
  - ii. GeoTracker Global ID.

- iii. Name of Responsible Agency [AGENCY NAME].
- iv. Address of Responsible Agency.
- v. Name of POTW [FACILITY NAME].
- vi. Address of POTW [FACILITY ADDRESS/PLACE ADDRESS].
- vii. Mailing address of POTW.
- viii. Name and title of POTW Point of Contact.
- ix. POTW Point of Contact phone number.
- x. POTW Point of Contact email address.
- xi. Current average annual flow (mgd).
- xii. Average flow during June-Sept 2019 (mgd).
- xiii. Types of wastewaters (e.g. industrial, domestic) received and estimated percentages of total flow (mgd) based on calendar year 2019.
- xiv. If wastewaters are received from industrial sources, provide a list of industry types contributing flow to the POTW and estimated percentage of flow for each type for the calendar year of 2019. Provide for each industrial type if the flow is continuous, periodic, and/or non-routine.
- xv. Any storage basins (non-percolation) in use? If so, how many, any unlined, how many with leak detections systems, and their frequency of use.
- xvi. Plans to recycle water to Title 22 standards within the next 5 years.
- xvii. Amount of sewage sludge and biosolids (by class type) produced in the calendar year of 2019.
- xviii. Disposal options used for sewage sludge and biosolids and estimate volume percentage for the calendar year of 2019.
- xix. Landfill leachate accepted at the facility and if so, provide the name of landfill, years accepted, and estimated volumes for the past 5 years.
- xx. Reverse osmosis concentrate/retentate produced at the facility and if so, the volume produced in 2019 and annual average produced for the past 5 years.
- xxi. PFAS sampling prior to this Order, PFAS sampling been performed in compliance with an Order/Permit/Monitoring Reporting Program and submitted to a Regional Water Quality Control Board, and PFAS sampling been performed for internal/informal testing by others for research.

#### ***Section D. POTW Online Questionnaire and Instructions***

1. This questionnaire will need to be filled out on **Adobe Acrobat** Software. This will ensure that your responses are correctly recorded. Please install this software prior to starting the questionnaire.

1. A free download of the Adobe Acrobat Reader software is available at the following link from Adobe's official website: <https://acrobat.adobe.com/us/en/acrobat/pdf-reader.html>. You can also fill this form out with Adobe Acrobat Pro DC software.
2. You will receive this questionnaire as an attachment in an email from [PFAS@waterboards.ca.gov](mailto:PFAS@waterboards.ca.gov). Download and save the file locally to your computer and open with Adobe Acrobat software. The questionnaire will also be available in GeoTracker to your GeoTracker Account using your GeoTracker Global ID.
3. Fill out the questionnaire using Adobe Acrobat. Please type your answers into the fillable spaces as provided in the questionnaire and **save** it. You can print this file for your records.
4. **Upload the completed questionnaire and any associated attachments (if necessary) using the following instructions into GeoTracker.**
  1. Go to the GeoTracker ESI login page:  
<https://geotracker.waterboards.ca.gov/esi/login.asp>
    - i. If you do not have an account, you can create one by clicking on the "Password Request" link.
  2. If you already have upload access to your facility record, please skip to step 7. If not, please continue to step 3.
  3. Once you are in your account, please go to the "Facility Management" section and click "Request Additional Facilities".

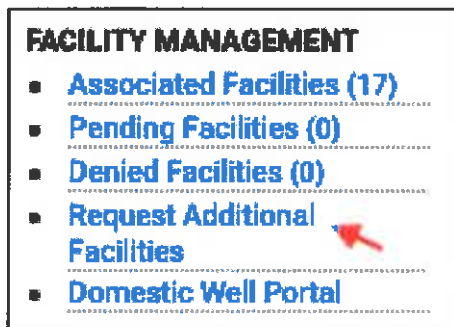

4. In the Global ID box, please type in the Global ID for the site and click the Search button. You can also search by facility name or address, but Global ID tends to be more reliable.

Global ID	Facility Name	Status	Street Name	City	County		
<input type="text"/>	<input type="text"/>	<input type="text"/>	<input type="text"/>	<input type="text"/>	<input type="text"/>	<input type="button" value="Search"/>	<input type="button" value="Reset"/>

5. Select the box next to the Global ID for the site and click the "Request Checked Facilities" button.

[AGW080012673 -1](#)

6. Once your request has been approved, you should be able to upload the document.
7. Go to the "Tools" section and click on "Upload EDD".



# Helendale Community Services District

**DATE:** October 15, 2020  
**TO:** Board of Directors  
**FROM:** Kimberly Cox, General Manager  
**BY:** Cheryl Vermette, Program Coordinator  
**SUBJECT:** Agenda item #7  
Discussion and Possible Action Regarding Parking Lot Lighting at the Community Center

---

**STAFF RECOMMENDATION:**

Staff requests input from the Board regarding this matter.

**STAFF REPORT:**

Staff has been researching lighting options for the park grant and found options for solar parking lot lights that may be of interest to the Board. Staff has not done extensive research on the pricing but wanted to bring this option to the Board for discussion.

Previously, the District had contemplated a larger parking area north of the Community Center that included lighting. However, with consideration of the grant the parking lot has been reduced significantly and the lighting has been eliminated for this initial phase. While researching options for the proposed park for the grant application, Staff discovered solar powered lighting that may be an option for the Board to consider. The benefit of this option is the extensive electrical backbone and transformer that would have to be installed. The light standards from one vendor are standard shoebox style with solar panels on the top of the fixture that are not visible from the ground. This may serve as a deterrent to theft.

Cost from one company was \$2,285 for each light fixture plus \$1,290 for each 25' pole. If the Board is interested in this option Staff can continue to research other vendors.

**FISCAL IMPACT:** Undetermined at this time.

**POSSIBLE MOTION:**

**ATTACHMENTS:** Lighting layout

## Lighting Layout

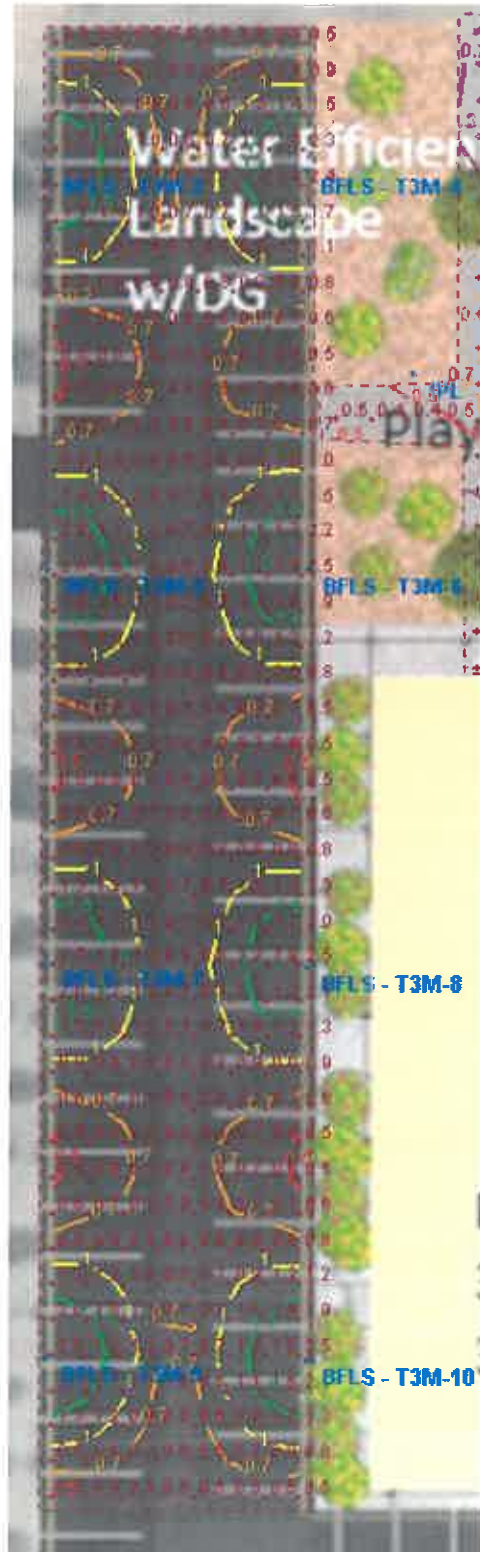



# Helendale Community Services District

**DATE:** October 15, 2020  
**TO:** Board of Directors  
**FROM:** Kimberly Cox, General Manager  
**BY:** Cheryl Vermette, Program Coordinator  
**SUBJECT:** Agenda item #8  
Discussion and Possible Action Regarding Cost of Park Elements for Grant Applications

---

**STAFF RECOMMENDATION:**

Staff seeks input from the Board regarding this item.

**STAFF REPORT:**

Staff has researched pricing on the features selected for the Statewide Parks Grant Application. Attached for the Board's information are estimated costs for the various park elements selected through the community park planning process. The Grant maximum award is \$8,500,000, however, there is some wisdom in not requesting the maximum amount. Currently, the estimated total for all of the elements is \$6,213,050.

Are there any elements that the Board would like to remove from the grant application?

Does the Board wish to make any modification to any of the fencing or pathways?

Does the Board wish to reduce the size of any of the elements?

The Board's input at this time would be helpful prior to solidifying the grant application for submittal by December 14, 2020.

**FISCAL IMPACT:** Unknown

**POSSIBLE MOTION:**

**ATTACHMENTS:** Grant Costs



**Attachment A: Grant Costs**

<b>Feature</b>	<b>Cost</b>
<b>NEW Outdoor Amphitheater</b>	<b>250,000.00</b>
<b>Outdoor Basketball Courts / Roller Hockey</b>	<b>100,000.00</b>
<b>NEW Community Garden boxes and Fence 100'x75' area (350 lineal ft. X \$33)</b>	<b>13,050.00</b>
<b>NEW Jogging/Walking Paths Concrete 4,500 lineal ft @ \$15/lineal ft</b>	<b>100,000.00</b>
<b>NEW Splashpad with shade cover and fencing</b>	<b>750,000.00</b>
<b>NEW Open Space/Demonstration Garden/Grass/Trees/Irrigation</b>	<b>300,000.00</b>
<b>NEW Picnic/Barbeque Areas/Gazebos</b>	<b>75,000.00</b>
<b>NEW ADA Playground features with poured in place surfacing</b>	<b>250,000.00</b>
<b>NEW Public Art</b>	<b>75,000.00</b>
<b>NEW Pump Track</b>	<b>350,000.00</b>
<b>NEW security safety lighting throughout the park (solar)</b>	<b>200,000.00</b>
<b>NEW Community Center with Senior Center 30,000 sq ft</b>	<b>3,500,000.00</b>
<b>NEW Mini golf Course</b>	<b>250,000.00</b>
<b>Fencing 2000 lineal feet @\$35.00/lineal foot</b>	<b>87,500.00</b>
<b>Total Request</b>	<b>6,213,050.00</b>